

FIRE PROTECTION WAFER BUTTERFLY VALVE F0811-300



APPROVED

Specifications:

Certification:

- Valves size 2", 2.5", 3", 4", 5", 6", 8", 10", 12".
- UL listed for all sizes.
- FM approved for size 2", 2.5", 3", 4", 5", 6".

Features:

- Vulcanized disc design for bubble-tight shutoff at 300PSI.
- Flag type position indicator.
- Low torque operation, high cycle life.
- Light weight.
- Stem has a multiple spline key structure. This transfers higher torque loads and provides exceptional reliability.
- With built-in supervisory switch.
- Top flange to ISO 5211/1.
- Flanges to ANSI B16.1 Class125, EN1092-2 PN10/16. (Other types available upon request)
- Fusion bonded epoxy coated interior and exterior to AWWA C550 standard.
- Working Pressure 300PSI. (available for 250PSI and 200PSI)
- Working Temperature -10°C to 82°C.



Installation Sheet for Gear Operator with Tamper Switch

Butterfly valves are provided with internal supervisory position switches. The tamper switch operates by a cam connected to the valve stem. The switch will change position and close within two (2) full turns of the hand wheel from the fully open position.

Switch #1:

For connection to the supervisory circuit

Normally closed: 2 Yellow

Normally open: 2 Red

Common: 2 White

Switch #2:

Auxiliary switch connected per authority

Normally closed: 1 Blue

Normally open: 1 Orange

Common: 1 Black

Ground Lead: 1 Green

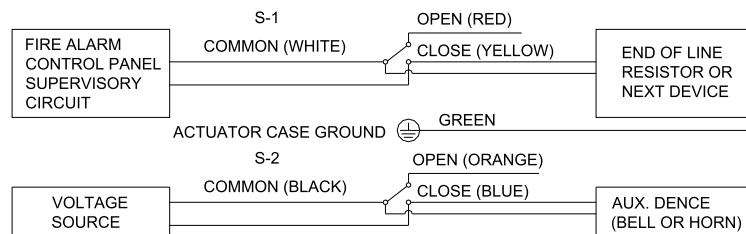

Notes:

1. Item no. VSION 021 C2.
2. Rated: 10A 125-250VAC.

The designs, materials and specifications shown are subject to change without notice due to the continuous development of our product.

Schematic

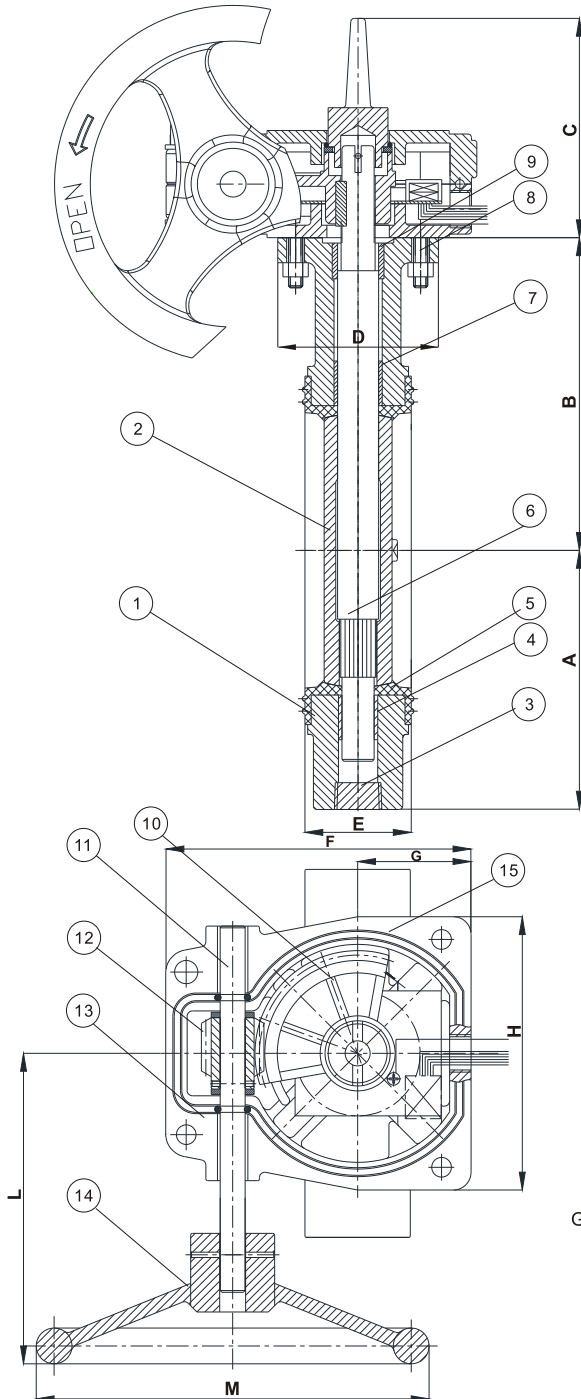

Components & Materials

1	Body	Ductile Iron A536 65-45-12
2	Disc	Ductile Iron A536 65-45-12
3	Plug	Carbon Steel/Chrome Plated
4	Lower Shaft Sleeve	Brass C67400
5	Seat	Rubber EPDM
6	Stem	Stainless Steel AISI 431
7	Upper Stem	Stainless Steel AISI 431
8	Bolts & Nuts	Carbon Steel/Zinc Plated
9	Upper Shaft Sleeve	Brass C67400
10	Worm Gear	Bronze C62300
11	Worm Shaft	Stainless Steel AISI 316
12	Worm	Stainless Steel AISI 316
13	Gasket	Rubber EPDM
14	Handwheel	Cast Iron A126 ClassB
15	Gear Box	Cast Iron A126 ClassB

Dimensions (mm/inch)

Size	A	B	D	E	C	F	G	H	L	M
2"	110 4.33	74 2.91	90 3.54	43 1.69	120 4.72	170 6.69	65 2.56	155 6.10	150 5.91	200 7.87
2.5"	118 4.65	85 3.35	90 3.54	46 1.81	120 4.72	170 6.69	65 2.56	155 6.10	150 5.91	200 7.87
3"	130 5.12	95 3.74	90 3.54	46 1.81	120 4.72	170 6.69	65 2.56	155 6.10	150 5.91	200 7.87
4"	145 5.71	115 4.53	90 3.54	52 2.05	120 4.72	170 6.69	65 2.56	155 6.10	150 5.91	200 7.87
5"	160 6.30	130 5.12	90 3.54	56 2.20	120 4.72	170 6.69	65 2.56	155 6.10	150 5.91	200 7.87
6"	175 6.89	145 5.71	90 3.54	56 2.20	120 4.72	170 6.69	65 2.56	155 6.10	150 5.91	200 7.87
8"	200 7.87	170 6.69	125 4.92	60 2.36	160 6.30	225 8.86	85 3.35	206 8.11	200 7.87	300 11.81
10"	250 9.84	208 8.19	125 4.92	68.5 2.70	160 6.30	225 8.86	85 3.35	206 8.11	200 7.87	300 11.81
12"	275 10.83	238 9.37	125 4.92	79.5 3.13	160 6.30	225 8.86	85 3.35	206 8.11	200 7.87	300 11.81

Internal Structure of Gear operator

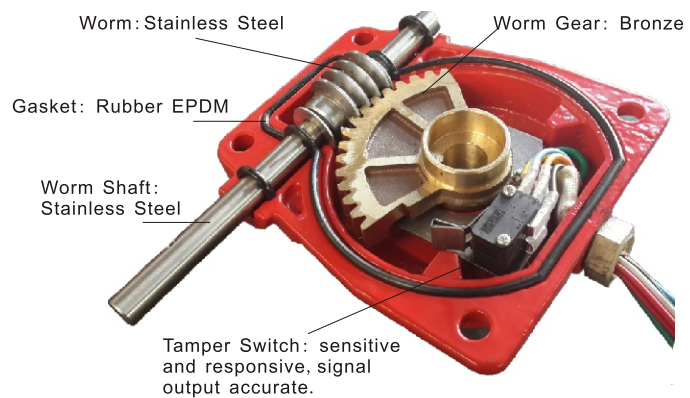

The designs, materials and specifications shown are subject to change without notice due to the continuous development of our product.

OS&Y RESILIENT SEATED GATE VALVE FLANGED ENDS 300PSI FIG · F0111 – 300

Specifications

- Complies with AWWA C515 Standard
- Heavy duty handwheel and attachment nut
- High quality graphite stem seal
- NPT plug on body
- Flanges to ANSI B16.1 Class125 (Other flange types available upon Request)
- UL Listed and FM Approved
- Working pressure:
300PSI
200PSI and 250PSI available on request
- Working temperature:
42° F – 180° F
- Corrosion protection:
Fusion Bonded Epoxy Coated Interior and Exterior to AWWA C550 Standard
- Installation:
Valves installed in horizontal piping systems should have the stems oriented vertically
Valves installed in vertical piping systems should have the stems oriented horizontally

Note:

Design and material are subject to change without notice.

Schematic

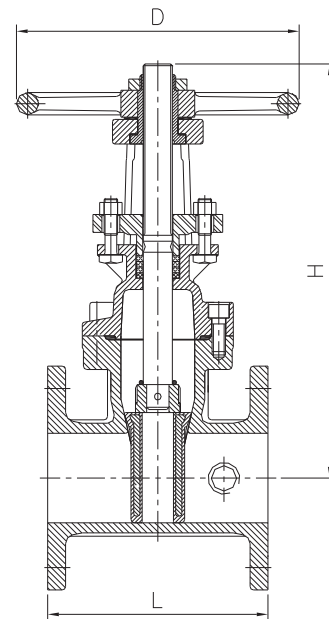

Material Specifications

Part Name	Material	ASTM Spec.
Body	Ductile Iron	A536 65-45-12
Wedge	Ductile Iron, EPDM Encapsulated	
Wedge Nut	Stainless Steel	AISI 304
Stem	Stainless Steel	AISI 420
Bonnet	Ductile Iron	A536 65-45-12
Gasket	Rubber	EPDM
Packing	Graphite	Commercial
Gland	Ductile Iron	A536 65-45-12
Yoke Nut	Bronze	B62 C83600
Handwheel	Ductile Iron	A536 65-45-12
Handwheel Nut	Ductile Iron	A536 65-45-12
NPT Plug	Malleable Iron	Commercial
Gland Bolt	Stainless Steel	AISI 316
Bonnet Bolt	Carbon Steel	A307 B

Dimensions (mm/inch)

Size	2.5"		3"		4"		5"		6"		8"		10"		12"	
	mm	inch	mm	inch	mm	inch	mm	inch	mm	inch	mm	inch	mm	inch	mm	inch
L	190.5	7-1/2	203	8	229	9	254	10	267	10-1/2	292	11-1/2	330	13	356	14
H (Open)	415	16-5/8	480	18-7/8	550	21-5/8	655	25-4/5	740	29-1/8	930	36-5/8	1130	44-1/2	1320	52
H (Close)	350	13-3/4	400	15-3/4	450	17-3/4	530	20-7/8	590	23-1/4	730	28-3/4	880	34-3/4	1020	40-1/6
D	184	7-1/4	254	10	254	10	305	12	305	12	356	14	445	17-1/2	445	17-1/2
Weight (LBS)	44		55		66		92.5		110		170		264		374	

WATERFLOW DETECTOR FIGURE F6001

Advantages:

- Designed for both indoor and outdoor use; temperature range 0° C to 68° C.
- Equipped with tamper resistant screws to prevent unauthorized entry.
- Two synchronized switches are enclosed in a durable terminal block. Terminals are easy to read and wire.
- Built-In mechanical time delay feature; minimizing the risk of false alarms due to pressure surges or air trapped in the system.
- The F6001 offers excellent performance during riser vibrations caused by large in-rushes of water.
- Designed and built for accuracy and repeatability.



Features:

- Flow sensitivity range: 4-10 GPM(15-38LPM).
- Contact rating: 8A@250VAC,
3A@24VDC,
2.5A@ 30VDC.
- Working Pressure: 450PSI.
- Working Temperature: 0°C to 68°C.
- Corrosion Protection: Fusion Bonded Epoxy Coated Interior and Exterior or Enamel Spray Paint, Interior and Exterior.
- UL Listed.
- FM Approved.
- GOST Certification.



The designs, materials and specifications shown are subject to change without notice due to the continuous development of our products.

Schematic

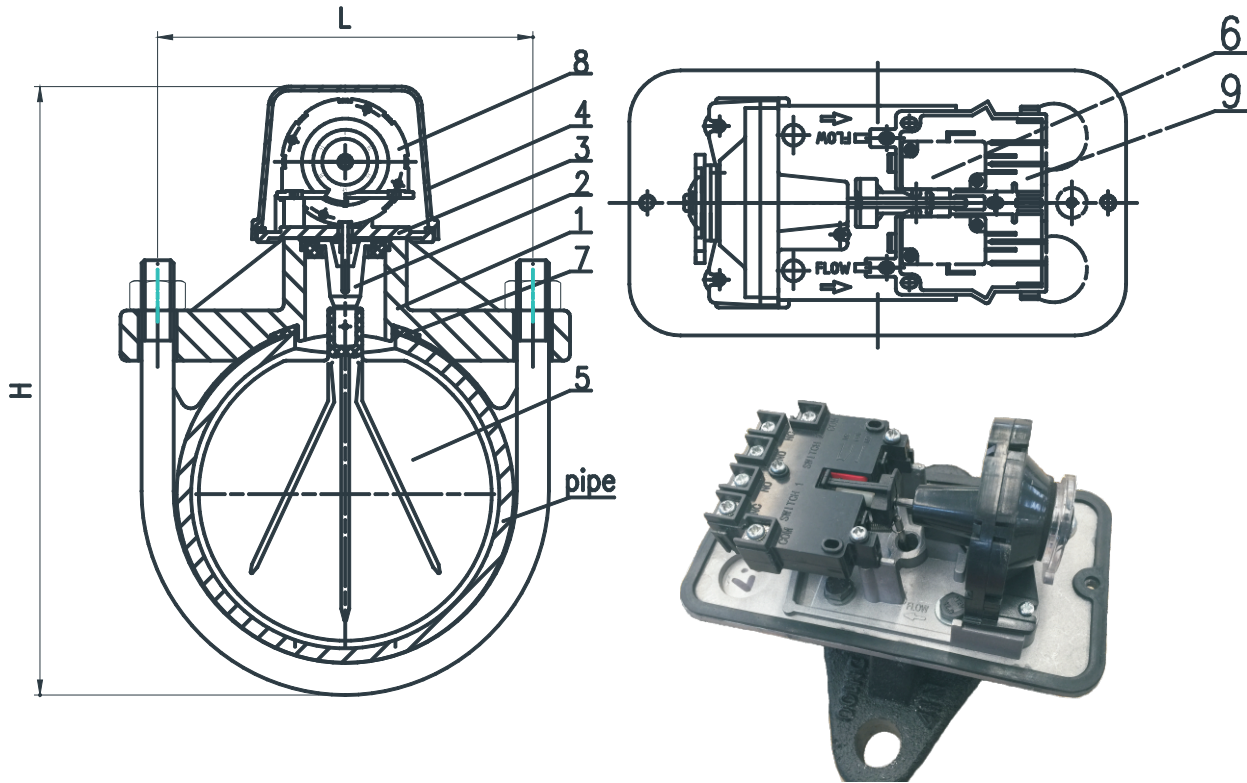

Material Specifications

No.	Part Name	Material
1	Saddle	DI, A536 65-45-12
2	Holder	SS304+EPDM
3	Plate	Aluminium Alloy
4	Cover	Aluminium Alloy
5	Paddle	Plastic
6	Microswitch	Plastic
7	Gasket	EPDM
8	Retarding device	Plastic
9	Terminal Box	Plastic

Dimensions (mm)

Size	DN50	DN65	DN80	DN100	DN125	DN150	DN200
L	84	92	104	133	160	187	239
H	190	200	220	245	270	300	350
Nominal Pipe Size OD.	60.3	73	88.9	114.3	141.3	168.3	219.1
Pipe Wall Thickness	2.77-3.91	3.05-5.16	3.05-5.49	3.05-6.02	3.40-6.55	3.40-7.11	3.76-8.18

The designs, materials and specifications shown are subject to change without notice due to the continuous development of our products.

NRS RESILIENT SEATED GATE VALVE FLANGED ENDS 300PSI FIG · F0211 – 300

Specifications

- Complies with AWWA C515 Standard
- Non-Rising Stem
- 4" to 12" Size provided with indicator post plate. Other sizes – plate provided only when specified at time or order
- Triple O-rings stem seal
- NPT plug on body
- Flanges to ANSI B16.1 Class125 (Other flange types available upon request)
- UL Listed and FM Approved
- Certified to NSF/ANSI 61 & 372

- Working pressure:
300PSI
200PSI and 250PSI available on request

- Working temperature:
42° F – 180° F

- Corrosion protection:
Fusion Bonded Epoxy Coated Interior and Exterior to AWWA C550 Standard

- Installation:
Valves installed in horizontal piping systems should have the stems oriented vertically
Valves installed in vertical piping systems should have the stems oriented horizontally

Note:
Design and material are subject to change without notice.

Material Specifications

Part Name	Material	ASTM Spec.
Body	Ductile Iron	A536 65-45-12
Wedge	Ductile Iron, EPDM Encapsulated	
Wedge Nut	Bronze	B62 C83600
Stem	Stainless Steel	AISI 420
Bonnet	Ductile Iron	A536 65-45-12
Gasket	Rubber	EPDM
Gland	Ductile Iron	A536 65-45-12
Thrust Collar	Bronze	B62 C83600
O-ring	Rubber	EPDM
Post Flange	Ductile Iron	A536 65-45-12
Operating Nut	Ductile Iron	A536 65-45-12
NPT Plug	Malleable Iron	Commercial
Post Flange Bolt	Stainless Steel	AISI 316
Bonnet Bolt	Stainless Steel	AISI 304

Schematic

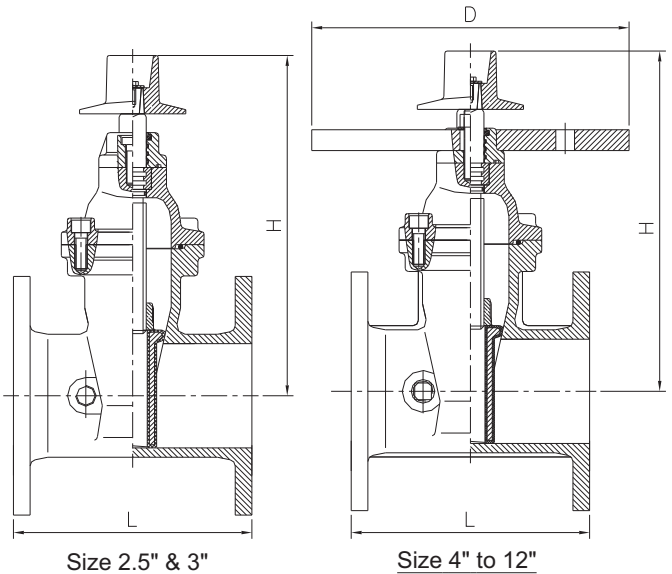
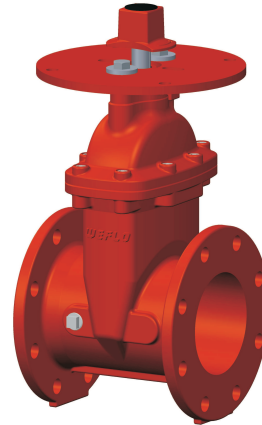

Dimensions (mm/inch)

Size	2.5"		3"		4"		5"		6"		8"		10"		12"	
	mm	inch	mm	inch	mm	inch	mm	inch	mm	inch	mm	inch	mm	inch	mm	inch
L	190.5	7-1/2	203	8	229	9	254	10	267	10-1/2	292	11-1/2	330	13	356	14
H	270	10-5/8	296	11-5/8	350	13-3/4	410	16-1/8	455	17-15/16	545	21-7/16	645	25-3/8	730	28-3/4
D	--	--	--	--	305	12	305	12	305	12	305	12	305	12	305	12
Weight (LBS)	31		41		64		79		103		161		235		339	

VERTICAL INDICATOR POST

FIG · F0600–IP

Specifications

- Indicates if the valve underneath is in the OPEN or SHUT position
- The indicator post provides a means of operating a buried or otherwise inaccessible valve
- The adjustment range of the indicator post is 34.5" to accommodate deeper buried valves and can be easily adjusted in the field
- The wrench handle fits over a "U" bracket on the barrel and may be fixed With a padlock to secure the operating wrench to the barrel
- Can be supplied in OPEN LEFT or OPEN RIGHT configurations from the factory, or the direction of opening can also be changed in the field
- UL Listed and FM Approved
- Corrosion Protection – internal and external red spray epoxy, RAL 3000

Material Specifications

No.	Component	Material
1	Hex Cap Screw	Carbon Steel ASTM A307B
2	Hex Nut	Carbon Steel ASTM A307B
3	Crane Coupling	Ductile Iron ASTM A536 Gr. 65-45-12
4	Cotter Pin	Stainless Steel AISI 304
5	Base Flange	Cast Iron ASTM A126 Class B
6	Hex Nut	Carbon Steel ASTM A307B
7	Hex Cap Screw	Carbon Steel ASTM A307B
8	Standpipe	Carbon Steel ASTM A53
9	Stem 1" Square	Carbon Steel AISI 1045
10	Body	Cast Iron ASTM A126 Class B
11	Locking Wrench	Ductile Iron ASTM A536 Gr. 65-45-12
12	Target Carrier Nut	Bronze ASTM B62 C83600 Stainless Steel AISI 304
13	Hex Cap Screw	Carbon Steel ASTM A307B
14	Hex Nut	Carbon Steel ASTM A307B
15	Hex Cap Screw	Carbon Steel ASTM A307B
16	Target	Cast Aluminium
17	Window Glass	Plexiglass
18	Gasket	PTFE
19	Operating Nut	Bronze ASTM B62 C83600 Stainless Steel AISI 304
20	Top Section	Cast Iron ASTM A126 Class B
21	Snap Ring	Stainless Steel AISI 1066
22	Plug	Malleable Iron
23	Square Nut	Carbon Steel ASTM A307B
24	Hex Cap Screw	Carbon Steel ASTM A307B

Schematic

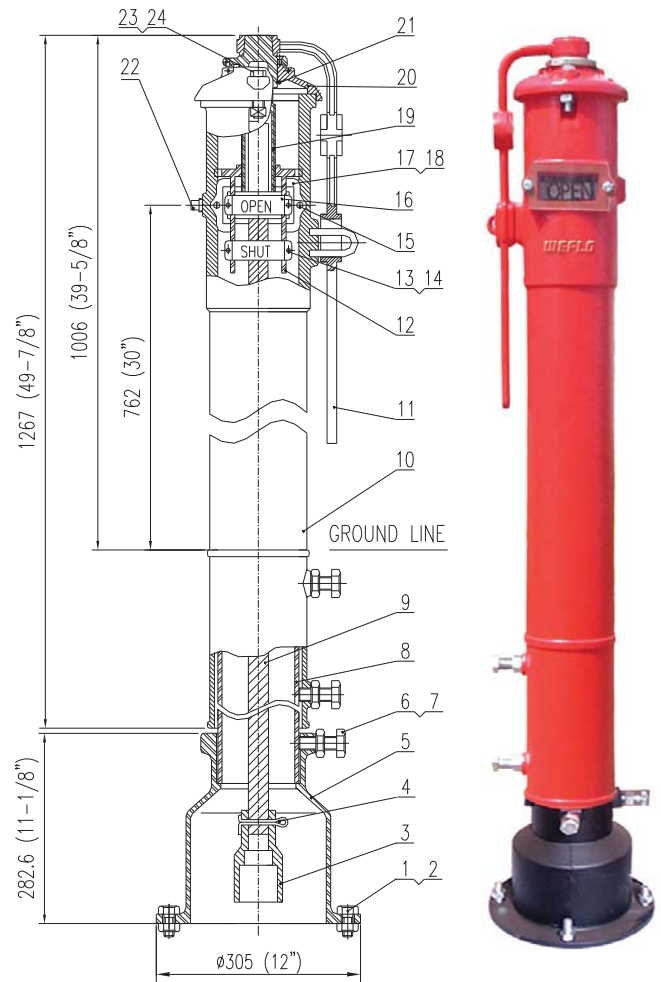

Field Adjustment

- Remove the top section of the upper barrel of the indicator post
- Cut the stem to the required length and adjust the standpipe to match up the GROUND LINE
- Set the OPEN and SHUT targets for the appropriate valve size
- Re-attach the top section of the upper barrel of the indicator post

SWING CHECK VALVE GROOVED ENDS 300PSI FIG · F0322–300

Specifications

- Full waterway design
- Seating type is resilient material to bronze seat construction
- Two test plugs included – installed on one side of valve body
- Grooved Ends to AWWA C606 Standard or Metric Dimensions
- UL Listed and FM Approved
- Working pressure:
300PSI
200PSI and 250PSI available on request
- Working temperature
42° F – 180° F
- Corrosion protection:
Fusion Bonded Epoxy Coated Interior and Exterior to AWWA C550 Standard
- Installation:
May be installed horizontally or vertically, for vertical installations, the flow must be in upward direction

Note:
Design and material are subject to change without notice.

Schematic

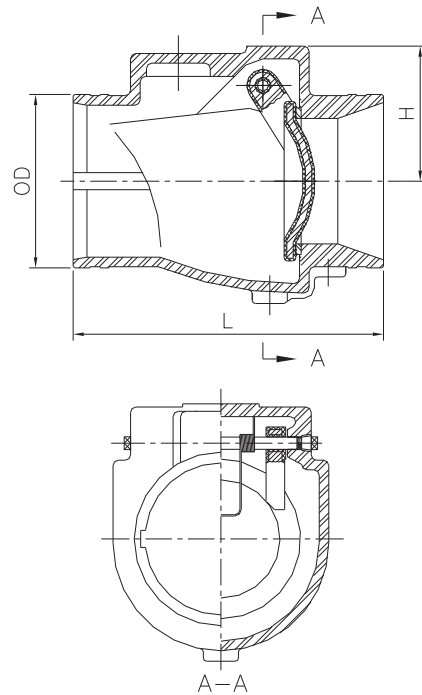

Material Specifications

Part Name	Material	ASTM Spec.
Body	Ductile Iron	A536 65-45-12
Seat Ring	Bronze	B62 C83600
Disc	DI and Rubber Encapsulated	DI+EPDM
Spindle	Stainless Steel	AISI 316
Spring	Stainless Steel	AISI 304
Plug	Stainless Steel	AISI 304
Washer	Rubber	EPDM

Dimensions (mm/inch)

Size	2.5"		3"		4"		5"		6"		8"		10"		12"	
	mm	inch	mm	inch	mm	inch	mm	inch	mm	inch	mm	inch	mm	inch	mm	inch
OD	73.0	2-7/8	88.9	3-1/2	114.3	4-1/2	139.7	5-1/2	165.1	6-1/2	219.1	8-5/8	273.0	10-3/4	323.9	12-3/4
	76.1	3					141.3	6-9/16	168.3	6-5/8						
L	203	8	213	8-3/8	245	9-5/8	267	10-1/2	292	11-1/2	356	14	432	17	495	19-1/2
H	74.5	2-15/16	78	3-1/16	102	4	112	4-7/16	133.5	5-1/4	160	6-5/16	195	7-11/16	215	8-1/2

Fire Hydrant Dry-Barrel, 250PSI FIG · F0733-250

Specifications

- Manufactured in accordance with AWWA C502 Standard
- UL Listed / FM Approved at 250 psi water working pressure rating
- (1) 4.5" Pumper Nozzle, (2) 2.5" Hose Nozzles. NH Thread. Other thread types available
- Multiple bury lengths available. Specify bury depth at time of order
- 6" Mechanical Joint Shoe to AWWA C111 Standard / 6" Flanged Shoe to ANSI B16.1, Class 125
- Specify Mechanical Joint or Flanged Shoe at time of order
- Traffic Flange model, with full "break-away" safety feature

- Working temperature:
42° F - 180° F

- Corrosion protection:
Liquid Epoxy Painted Interior and Exterior to AWWA C550 Standard

Note:

Design and material are subject to change without notice.

Schematic

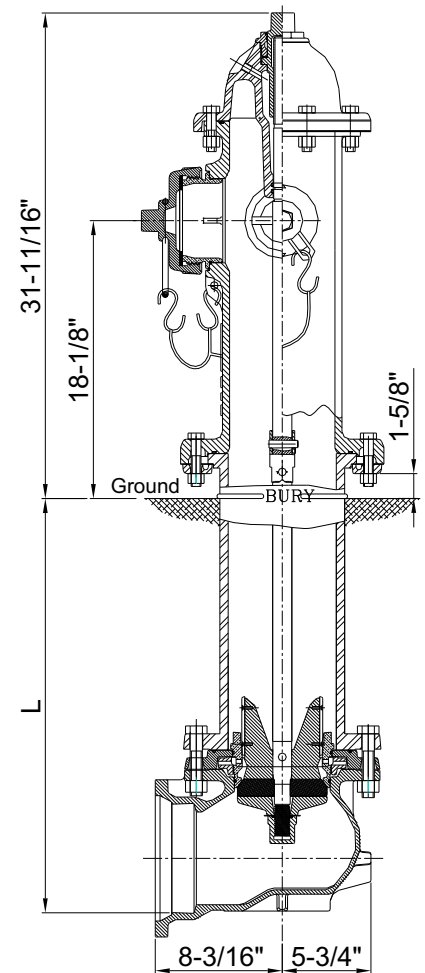

Material Specifications

Part Name	Material	ASTM Spec.
Operating Nut	Bronze	ASTM B62
Hold Down Nut	Bronze	ASTM B62
O-Ring	NBR	Commercial
Bonnet	Cast Iron	A126 Class B
Bonnet Bolt & Nut	Stainless Steel	AISI 201
Upper Rod	Carbon Steel	AISI 1045
Pumper Nozzle	Bronze	ASTM B62
Pumper Nozzle Gasket	NBR	Commercial
Hose Nozzle	Bronze	ASTM B62
Hose Nozzle Gasket	NBR	Commercial
Pumper Nozzle Cap	Cast Iron	A126 Class B
Hose Nozzle Cap	Cast Iron	A126 Class B
Cap Chain	Carbon Steel	Plated
Upper Barrel	Ductile Iron	A536 65-45-12
Safety Coupling	Stainless Steel	A890
Safety Flange Bolt & Nut	Stainless Steel	AISI 201
Safety Flange	Ductile Iron	A536 65-45-12
Lower Rod	Carbon Steel	AISI 1045
Lower Barrel	Ductile Iron	A536 65-45-12
Stem Pin	Stainless Steel	A276
Drain Ring Housing	Ductile Iron	A536 65-45-12
Drain Ring	Bronze	ASTM B62
Seat Ring	Bronze	ASTM B62
Bottom Plate	Ductile Iron	A536 65-45-12
Disc Ring	NBR	Commercial
Bottom Plate Nut	Ductile Iron	A536 65-45-12
Elbow	Ductile Iron	A536 65-45-12

Dimensions (inch)

L	Weight (kg)
3' - 0"	170
3' - 6"	178
4' - 0"	183
4' - 6"	196
5' - 0"	200
5' - 6"	210
6' - 0"	215
6' - 6"	224

ISLAK ALARM VANASI MONTAJ ŞEMASI

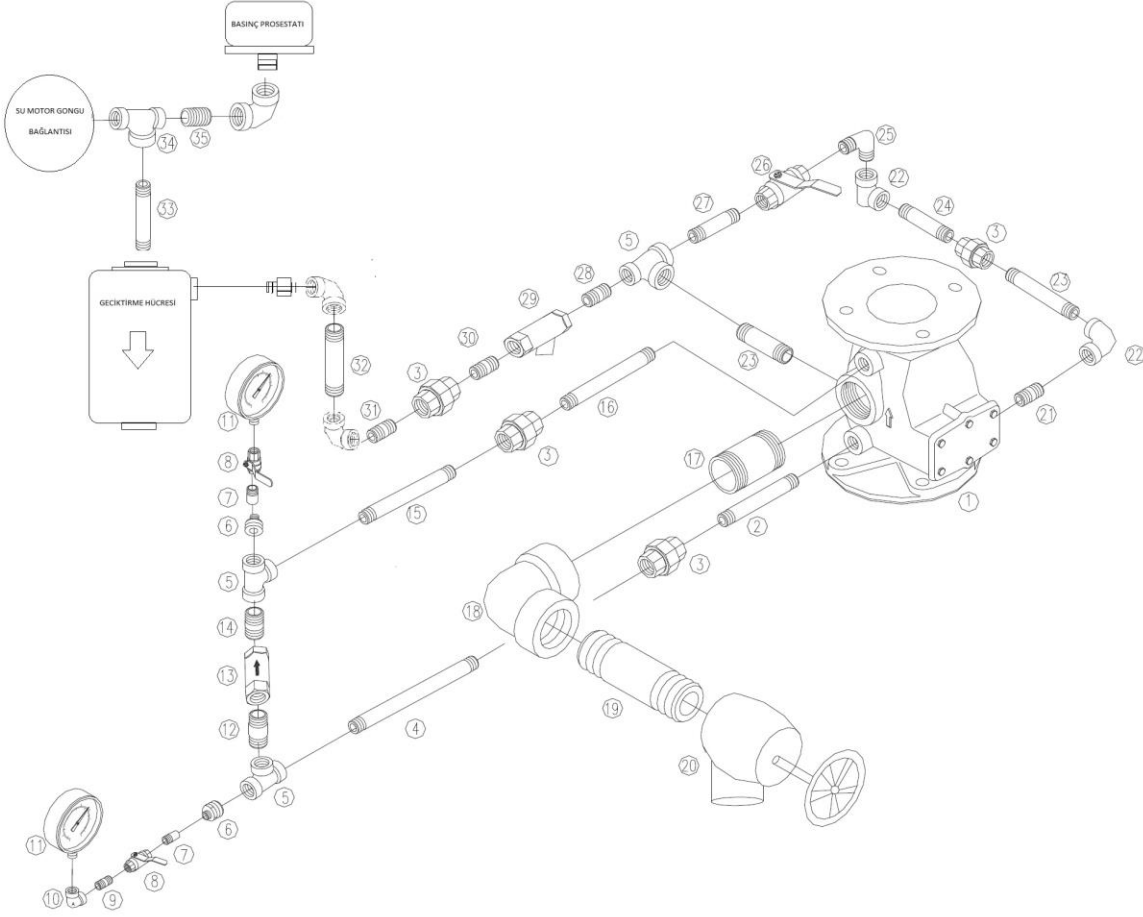

SU MOTOR GONGU MONTAJ DETAYI

