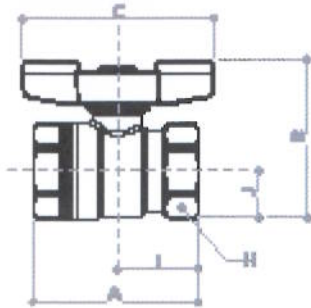

TECHNICAL DATA
R850 AND R850V BALL VALVE WITH FULL PORT
R851

MATERIALS

Body: CW617N - EN 12165 hot-pressed brass, chrome plated
 Sleeve: CW617N - EN 12165 hot-pressed brass, chrome plated
 Stem: CW614N - EN 12164 bar turned brass, with inner and outer anti-friction rings and double sealing O-ring
 Ball: CW617N brass, chrome plated
 Gaskets: PTFE with low friction profile
 Handle: painted aluminium T-handle
 Nut: with anti-corrosion coating, guarantee seal and hologram

FIELD OF APPLICATION

Max. working conditions with dry saturated steam: 185°C at 1,05 MPa (10,5 bar)
 Max. working pressure with water and not dangerous gas: 3,5 MPa (35 bar), from 1/4" to 3/4"
 2,8 MPa (28 bar), from 1" to 1 1/4"
 Max. operating pressure (MOP) with gas: 0,5 MPa (5bar)
 Max. operating working pressure with fluid hydrocarbons: 1,2 MPa (12bar)

SIZE	DN	A	I	B	J	C	H
1/4"	8	43	21	35	10	40	17
3/8"	10	46	23	47	12	63	20
1/2"	15	53	27	54	16	63	25
3/4"	20	60	30	63	20	73	31
1"	25	74	37	72	24	73	38
1 1/4"	32	84	42	82	29	73	47

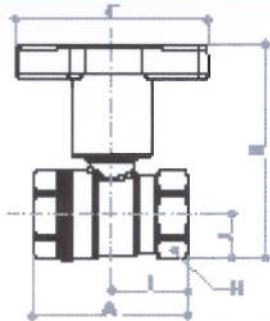
R851TH

MATERIALS

Body: CW617N - EN 12165 hot-pressed brass, chrome plated
 Sleeve: CW617N - EN 12165 hot-pressed brass, chrome plated
 Stem: CW614N - EN 12164 bar turned brass, with inner and outer anti-friction rings and double sealing O-ring
 Ball: CW617N brass, chrome plated
 Gaskets: PTFE with low friction profile
 Handle: glass-charged polyamide extended T with reinforcing plate on the steel base
 Nut: with anti-corrosion coating, guarantee seal and hologram

FIELD OF APPLICATION

Max. working conditions with dry saturated steam: 185°C at 1,05 MPa (10,5 bar)
 Max. working pressure with water and not dangerous gas: 3,5 MPa (35 bar), from 3/8" to 3/4"
 2,8 MPa (28 bar), from 1" to 2"
 Max. operating pressure (MOP) with gas: 0,5 MPa (5bar)
 Max. operating working pressure with fluid hydrocarbons: 1,2 MPa (12bar)

SIZE	DN	A	I	B	J	C	H
3/8"	10	46	23	73	12	78	20
1/2"	15	53	27	80	16	78	25
3/4"	20	60	30	89	20	78	31
1"	25	74	37	98	24	78	38
1 1/4"	32	84	42	108	29	78	47
1 1/2"	40	95	47	141	35	96	54
2"	50	109	54	156	43	96	66

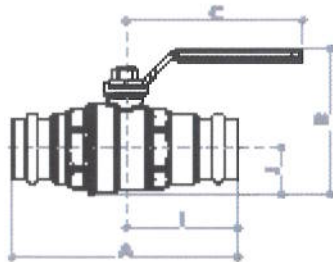
R850V-R850VW

MATERIALS

Body: CW617N - EN 12165 hot-pressed brass, with double yellow o-ring complying with EN 549 and EN 682 standards for gas and fluid hydrocarbons systems for R850V model, with double black o-ring made of food-use EPDM complying with EN 681-1 for R850VW model.
 Nipple: CW617N - EN 12165 hot-pressed brass, with double yellow o-ring complying with EN 549 and EN 682 standards for gas and fluid hydrocarbons systems for R850V model, with double black o-ring made of food-use EPDM complying with EN 681-1 for R850VW model.
 Stem: CW614N - EN 12164 machined brass from bars, with internal and external antifriction rings and double sealing o-ring
 Ball: CW617N brass, chrome plated
 Washers: PTFE with low friction profile
 Handle: steel lever with plasticized coating
 Nut: with anti-corrosion coating, guarantee seal and hologram

FIELD OF APPLICATION

Max. working pressure with water: 2,8 MPa (28 bar)
 Max. operating working temperature: 110°C

SIZE	DN	A	I	B	J	C
ø15	15	100	50	53	16	77
ø22	20	116	58	69	20	94
ø28	25	122	61	77	25	94
ø35	32	130	65	87	30	94
ø42	40	148	74	106	36	136