

**CHROME PLATED BALL VALVE
FULL PORT**

Description

Chrome plated ball valve, female connections and lever handle. Full port.

Technical data
• Max. working conditions with dry saturated steam:

185°C at 1,05 MPa (10,5 bar)

• Max. working pressure with water and not dangerous gas:

3,5 MPa (35 bar), from 1/4" to 3/4" 2,8 MPa (28 bar), from 1" to 2"

• Max. operating pressure (MOP) with gas:

0,5 MPa (5bar)

• Max. operating working pressure with fluid hydrocarbons:

1,2 MPa (12bar)

Materials

- **Body:** CW617N - EN 12165 hot-pressed brass, chrome plated
- **Sleeve:** CW617N - EN 12165 hot-pressed brass, chrome plated
- **Stem:** CW614N – EN 12164 bar turned brass, with inner and outer anti-friction rings and double sealing O-ring
- **Ball:** CW617N brass, chrome plated
- **Gaskets:** PTFE with low friction profile
- **Handle:** steel lever with plasticized coating
- **Nut:** with anti-corrosion coating, guarantee seal and hologram

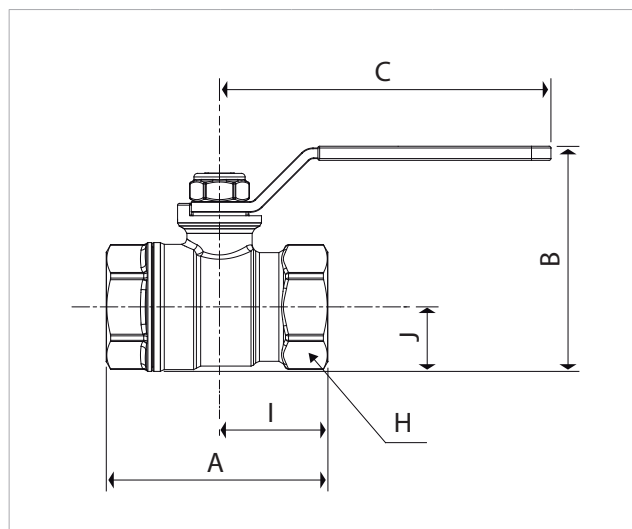
Size

Size	DN	A [mm]	I [mm]	B [mm]	J [mm]	C [mm]	H [mm]	Kv
1/4"	8	43	21	37	10	43	17	6,6
3/8"	10	46	23	45	12	77	20	6,7
1/2"	15	53	27	51	16	77	25	12,7
3/4"	20	60	30	67	20	94	31	24,6
1"	25	74	37	76	24	94	38	48,5
1 1/4"	32	84	42	85	29	94	47	98,0
1 1/2"	40	95	47	104	35	136	54	140
2"	50	109	54	120	43	136	66	211

Additional information

For additional information please check the Giacomini website at the following address: www.giacomini.com

+39 0322 923 372

+39 0322 923 255

consulenza.prodotti@giacomini.com

This pamphlet is merely for information purposes. Giacomini S.p.A. retains the right to make modifications for technical or commercial reasons, without prior notice, to the items described in this pamphlet. The information described in this technical pamphlet does not exempt the user from following carefully the existing regulations and norms on good workmanship.

Giacomini S.p.A. Via per Alzo 39, I-28017 San Maurizio d'Opaglio (NO) Italy