



## FIRE PROTECTION PRODUCTS

<b>A53</b>	Gate Valve 300 lb. Rated	4
<b>A53G</b>	Single Hydrant Gate Valve	4
<b>A50</b>	Angle Hose Valve with Hydrolator	5
<b>A51</b>	Angle Hose Valve with Hydrolator	5
<b>A55</b>	Angle Hose Valve 300 lb. Rated	6
<b>A56</b>	Angle Hose Valve 300 lb. Rated	6
<b>A85</b>	Straight Globe Valve 300 lb. Rated	7
<b>A86</b>	Straight Globe Valve 300 lb. Rated	7
<b>A155</b>	Pressure Reducing Device Angle Valve	8
<b>A156</b>	Pressure Reducing Device Angle Valve	8
<b>A201</b>	Angle Pressure Reducing Valve with Cheking Device	9
<b>A202</b>	Angle Pressure Reducing Valve	9
<b>A203</b>	Straight Pressure Reducing Valve with Cheking Device	10
<b>A204</b>	Straight Pressure Reducing Valve	10
<b>A170</b>	Monitor Switch Adapter	11
<b>A95</b>	Straight Single Clapper Two-Way Inlets	12
<b>A96</b>	90° Single Clapper Two-Way Inlets	12
<b>A97</b>	Straight Two-Way Male Outlets	13
<b>A97</b>	Straight Three-Way Male Outlets	13
<b>A98</b>	90° Two-Way-Male Outlets	14
<b>A98</b>	90° Three-Way Male Outlets	14
<b>A101</b>	Straight Concealed Siamese	15
<b>A102</b>	90° Concealed Siamese	15
<b>A105</b>	Straight Double Clapper Two-Way Inlets	16
<b>A105</b>	Straight Triple Clapper Three-Way Inlets	16
<b>A106</b>	90° Double Clapper Two-Way Inlets	17
<b>A106</b>	90° Triple Clapper Three-Way Inlets	17
<b>A103</b>	Square Plate	18
<b>A99</b>	Leader Line Dual Ball Valve	19
<b>A65</b>	Hose Rack Mounting Nipple	19
<b>A75</b>	Female to Male Reducer	20
<b>A90</b>	Female Open Snoot	20
<b>A91</b>	Male Open Snoot	21
<b>A83</b>	Female Open Snoot Base	21
<b>A87</b>	Male Open Snoot Base	22
<b>A88</b>	Male to Male Adapter	22
<b>A88G</b>	Male to Groove Adapter	23
<b>A89</b>	Swivel	23
<b>A92</b>	Male to Male Adapter	24
<b>A93</b>	Female to Male Adapter	24
<b>A94</b>	Female to Female Adapter	25
<b>A104</b>	Bushing	25
<b>A90C</b>	Female Check Snoot	26
<b>A91C</b>	Male Check Snoot	26

### FLUSH FIRE DEPT. INLET CONNECTIONS

#### CLAPPER SNOOT TYPE

<b>A111</b>	End Outlet body	27
<b>A112</b>	Back Outlet body	27
<b>A113</b>	Angle Outlet body	28

### FLUSH FIRE DEPT. INLET CONNECTIONS

#### CLAPPER SNOOT TYPE - Four way Square Body

<b>A114</b>	Back Outlet body	28
<b>A115</b>	Angle Outlet body	29

### FLUSH FIRE DEPT. INLET CONNECTIONS

#### CLAPPER BODY TYPE

<b>A121</b>	End Outlet body	29
<b>A122</b>	Back Outlet body	30
<b>A123</b>	Angle Outlet body	30

### FLUSH FIRE DEPT. INLET CONNECTIONS

#### CLAPPER BODY TYPE - Four way Square Body

<b>A124</b>	Back Outlet body	31
<b>A125</b>	Angle Outlet body	31

<b>A190T</b>	Single Inlet Connection	32
<b>A140</b>	Swing Check Valve	32
<b>A80</b>	Cap and Chain	33
<b>A81</b>	Plug and Chain	33
<b>A80P</b>	Cap and Chain in Plastic	34
<b>A80PC</b>	Cap and Chain in Plastic Chrome Plated	34
<b>A70</b>	Double Jacket Brass Coupling	35-36
<b>A70</b>	Single Jacket Brass Coupling	37
<b>A71</b>	Forestry Coupling	37
<b>A7A</b>	Adjustable Fog Nozzle	38
<b>A7B</b>	Adjustable Fog Nozzle with Bumper	38
<b>A7B</b>	Storz Adjustable Fog Nozzle with Bumper	39
<b>A7BP</b>	Plastic Adjustable Fog Nozzle with Bumper	39
<b>A58</b>	Automatic Ball Drip	40
<b>A59</b>	Line-Tester	40
<b>A91AD</b>	Brass Automatic Drain Valve	41
<b>R910</b>	Full Port Ball Valve	41
<b>A61</b>	Test and drain valve	42

<b>Quantity</b>	43
-----------------	----

Please always indicate your requirements using our abbreviations and part numbers.  
On request Computer Programs (IBM or IBM compatible) on Pressure Control Valves are available.

Thread  
M= Male  
F= Female

Lugs  
R= Rocker Lug  
P= Pin Lug

RB= Rough Brass  
RC= Rough Chrome  
PB= Polished Brass  
PC= Polished Chrome  
RP= Red Painted



FIRE PROTECTION PRODUCTS

CISO is a member of  
**IONet**  
www.ionet-certification.com

IONet, the association of the world's first class certification bodies, is the largest provider of management System Certification in the world. IONet is composed of more than 30 bodies and counts over 150 subsidiaries all over the globe.

**ICIM**  
www.icim.it

CERTIFICATO n. 0006/5  
CERTIFICATE No.

SI CERTIFICA CHE IL SISTEMA DI GESTIONE PER LA QUALITÀ DI  
WE HEREBY CERTIFY THAT THE QUALITY MANAGEMENT SYSTEM OPERATED BY

**GIACOMINI S.p.A.**

UNITA' OPERATIVE  
OPERATIVE UNITS

Sede e Unità Operativa  
Via per Alzo, 39 - 28017 S. Maurizio d'Opaglio (NO)  
Unità Operativa  
Via Bisavola, 4 - 37014 Castelnuovo del Garda (VR)  
Via Brughiere, 29 - 28017 S. Maurizio d'Opaglio (NO)  
Italia

E' CONFORME ALLA NORMA  
IS IN COMPLIANCE WITH THE STANDARD  
**UNI EN ISO 9001:2000**

PER LE SEGUENTI ATTIVITA'  
FOR THE FOLLOWING ACTIVITIES  
EA: 18

Progettazione e produzione di : valvole per impianti di climatizzazione, raccordi in ottone, valvole a sfera, valvole di zona e saracinesche, tubi e raccordi in materie plastiche per sanitari e radianti. Assemblaggio radiatori.  
Design and production of : heating and cooling system manifolds, brass fittings, ball valves, safety valves, zone pipes and fittings for thermal, water, sanitary system Radiators assembly.

Referirsi al Manuale della Qualità per l'applicabilità dei requisiti della  
Refer to Quality Manual for details of application to ISO 9001:2000

Il presente certificato è soggetto al regolamento per la certificazione dei sistemi di gestione per la qualità.  
The use and the validity of this certificate shall satisfy the requirements of the rules for the certification of company environmental management systems.

Data emissione  
First issue  
23/07/1990

Emissione corrente  
Current issue  
24/07/2005

*Handwritten signature*

ICIM S.p.A. - PIAZZA A. DIAZ, 2 -

**SINCERT**  
Società di Certificazione  
Membro degli Accordi di Mutuo Riconoscimento EA e IAF  
Signatory of EA and IAF Mutual Recognition Agreements

CISO is a member of  
**IONet**  
www.ionet-certification.com

IONet, the association of the world's first class certification bodies, is the largest provider of management System Certification in the world. IONet is composed of more than 30 bodies and counts over 150 subsidiaries all over the globe.

**ICIM**  
www.icim.it

CERTIFICATO n. 0032A/1  
CERTIFICATE No.

SI CERTIFICA CHE IL SISTEMA DI GESTIONE AMBIENTALE DI  
WE HEREBY CERTIFY THAT THE ENVIRONMENTAL MANAGEMENT SYSTEM OPERATED BY

**GIACOMINI S.p.A.**

UNITA' OPERATIVE  
OPERATIVE UNITS

Via Brughiere, 29 - 28017 S. Maurizio D'Opaglio (NO)

E' CONFORME ALLA NORMA  
IS IN COMPLIANCE WITH THE STANDARD  
**UNI EN ISO 14001:2004**

PER LE SEGUENTI ATTIVITA'  
FOR THE FOLLOWING ACTIVITIES  
EA: 18

Produzione di componenti e raccordi in materiali sintetici per impianti idrotermosanitari mediante stampaggio ad iniezione ed assemblaggio per incollaggio e per saldatura. Estrusione di tubi per uso sanitario o per riscaldamento/raffrescamento.  
Production of components and fittings from synthetic materials for hydro-termosanitary systems through injection moulding and glueing and welding assembly. Extrusion of pipes for sanitary or heating/cooling use

Il presente certificato è soggetto al regolamento per la certificazione dei sistemi di gestione ambientale delle aziende.  
The use and the validity of this certificate shall satisfy the requirements of the rules for the certification of company environmental management systems.

Data emissione  
First issue  
19/09/2001

Data corrente  
Current issue  
28/07/2005

Data di scadenza  
Expiring date  
18/09/2007

*Handwritten signature*

ICIM S.p.A. - PIAZZA A. DIAZ, 2 - 20123 MILANO

CISO è la Federazione Italiana di Organismi di Certificazione dei sistemi di gestione aziendale  
CISO is the Italian Federation of management system Certification Bodies

**FEDERAZIONE  
CISQ  
eco**  
www.cisq.com

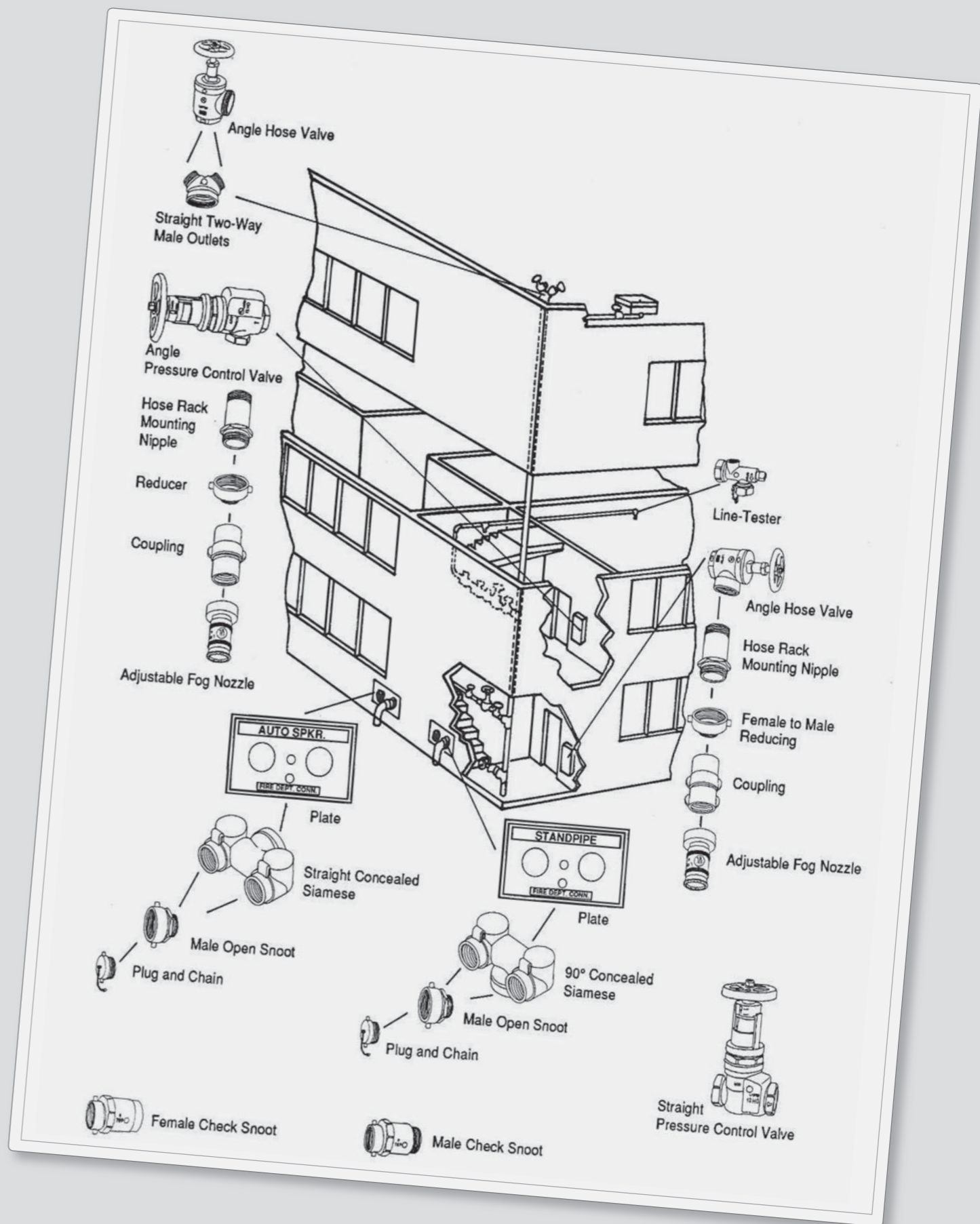





**FIRE PROTECTION PRODUCTS**

**Gate Valve 300 Lb. Rated**

**A53**



► Straightway pattern, non-rising stem, 300 lb. hose gate valves are intended for use on standpipes, fire pumps and hydrants.

FEMALE X MALE

**Standard equipment:**  
Female NPT inlet x male hose thread outlet, forged brass with red hand wheel, solid wedge disc with tapered seats.  
Available without cap and chain.

**Optional Finishes:**  
PB  
RC  
PC

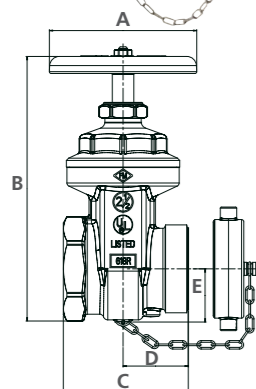

SPECIFY THREAD

CERTIFICATIONS	
APPROVED	LISTED 618R

a	b
2 1/2"	2 1/2"
3"	2 1/2"

	2" x 2 1/2"	3" x 2 1/2"
A	5 5/32"	5 5/32"
B	9 19/64"	9 19/64"
C	4 11/32"	4 17/32"
D	2 17/64"	2 17/64"
E	1 57/64"	1 57/64"

**Angle Hose Valve With Hydrolator**

**A50**



► Used with a Fire Hose Rack Assembly, or as a Fire Dept. outlet connection.

DOUBLE FEMALE

**Standard equipment:**  
Female NPT inlet and outlet forged brass valve.  
Red hand wheel.

**Optional Finishes:**  
PB  
RC  
PC

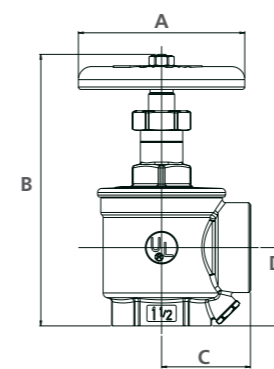

CERTIFICATIONS	
	CE x 589

a	b
1 1/2"	1 1/2"

	1 1/2" x 1 1/2"
A	4 1/64"
B	7 11/16"
C	2 9/64"
D	1 57/64"

**Single Hydrant Gate Valve**

**A53G**



► Straightway pattern, non-rising stem, 300 lb. hose gate valves are intended for use on standpipes, fire pumps and hydrants.

**Standard equipment:**  
Brass body with brass trim, pin lug, female hose thread swivel inlet x male hose thread outlet.  
Red hand wheel.

**Note:**  
Particularly used when space limitation or appearance preclude a permanent type installation.

**Optional Trim:**  
Swivel inlet with rocker lugs.

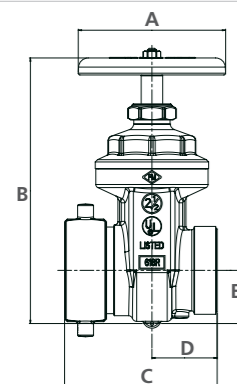

SPECIFY THREAD

CERTIFICATIONS	
	LISTED 618R

a	b
2 1/2"	2 1/2"

	2" x 2 1/2"
A	5 5/32"
B	9 19/64"
C	5 13/64"
D	2 17/64"
E	1 57/64"

**Angle Hose Valve With Hydrolator**

**A51**



► Used with a Fire Hose Rack Assembly, or as a Fire Dept. outlet connection.

FEMALE x MALE

**Standard equipment:**  
Female NPT inlet x male hose thread outlet forged brass valve.  
Red hand wheel.

**Optional Finishes:**  
PB

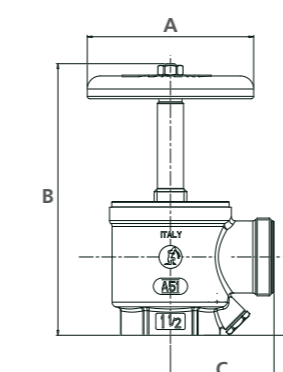

CERTIFICATIONS	
	CE x 589

a	b
1 1/2"	1 1/2"

	1 1/2" x 1 1/2"
A	4 1/64"
B	7 11/16"
C	2 1/2"
D	1 57/64"



**FIRE PROTECTION PRODUCTS**

Angle Hose Valve 300 Lb. Rated

**A55**



► Used with a Fire Hose Rack Assembly, or as a Fire Dept. outlet connection.

DOUBLE FEMALE

**Standard equipment:**  
Female NPT inlet and outlet forged brass valve.  
Red hand wheel.

**Optional Finishes:**

- PB
- RC
- PC

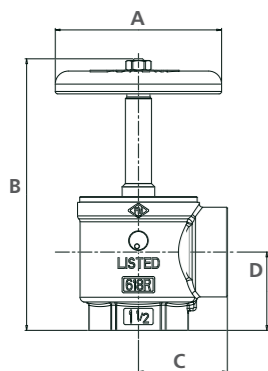

CERTIFICATIONS



APPROVED CE x 589 LISTED 618R

	a	b
	1 1/2"	1 1/2"
	2 1/2"	2 1/2"

	1 1/2" x 1 1/2"	2 1/2" x 2 1/2"
A	4 1/64"	5 1/8"
B	7 11/16"	10 9/16"
C	2 9/64"	3 5/32"
D	1 57/64"	2 41/64"

Straight Globe Hose Valve 300 Lb. Rated

**A85**



► Used with a Fire Hose Rack Assembly, or as a Fire Dept. outlet connection.  
Ideal for wet and combination system.

DOUBLE FEMALE

**Standard equipment:**  
Female NPT inlet and outlet cast brass valve, 300 lb.  
Red hand wheel.

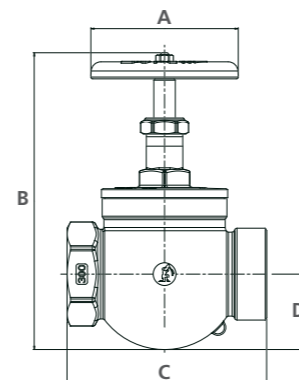

CERTIFICATIONS



CE x 589

	a	b
	2 1/2"	2 1/2"

	2 1/2" x 2 1/2"
A	5 1/8"
B	10 53/64"
C	6 15/16"
D	2 5/8"

Angle Hose Valve 300 Lb. Rated

**A56**



► Used with a Fire Hose Rack Assembly, or as a Fire Dept. outlet connection.

FEMALE X MALE

**Standard equipment:**  
Female NPT inlet x male hose thread outlet forged brass valve.  
Red hand wheel.

**Optional Finishes:**

- PB
- RC
- PC

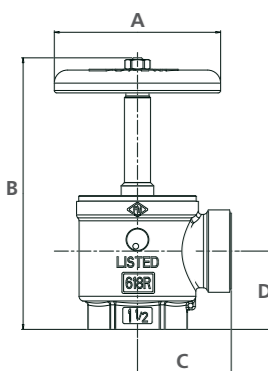

SPECIFY THREAD

CERTIFICATIONS



APPROVED CE x 589 LISTED 618R

	a	b
	1 1/2"	1 1/2"
	2 1/2"	2 1/2"

	1 1/2" x 1 1/2"	2 1/2" x 2 1/2"
A	4 1/64"	5 1/8"
B	7 11/16"	10 9/16"
C	2 17/64"	3 3/16"
D	1 57/64"	2 41/64"

Straight Globe Hose Valve 300 Lb. Rated

**A86**



► Used with a Fire Hose Rack Assembly, or as a Fire Dept. outlet connection.  
Ideal for wet and combination system.

FEMALE X MALE

**Standard equipment:**  
Female NPT inlet x male hose thread outlet cast brass valve, 300 lb.  
Red hand wheel.

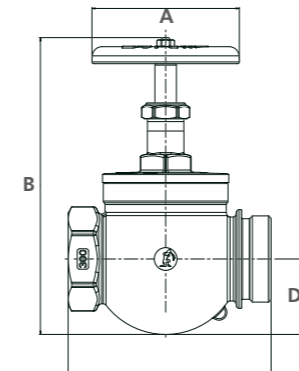

SPECIFY THREAD

CERTIFICATIONS



CE x 589

	a	b
	2 1/2"	2 1/2"

	2 1/2" x 2 1/2"
A	5 1/8"
B	10 53/64"
C	7 3/64"
D	2 5/8"



**FIRE PROTECTION PRODUCTS**

**Pressure Reducing Device Angle Valve 175 Lb. Rated**

**A155**

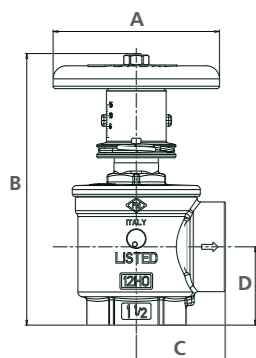

► Adjustable restriction of residual pressures up to 175 lb. Locking pin device restricts full opening of valve by untrained personnel, pin may be removed by firefighters to allow full opening of valve.

DOUBLE FEMALE

Standard equipment:

Female NPT inlet and outlet forged brass valve.  
Red hand wheel.

Optional Finishes:

PB  
RC  
PC

CERTIFICATIONS	
APPROVED CE x 1258 LISTED 12HO	

	a	b
	1 1/2"	1 1/2"
	2 1/2"	2 1/2"

	1 1/2" x 1 1/2"	2 1/2" x 2 1/2"
A	4 1/64"	5 1/8"
B	7 3/32"	9 31/32"
C	2 9/64"	3 5/16"
D	1 57/64"	2 41/64"

**Angle Pressure Reducing Valve With Checking Device**

**A201**

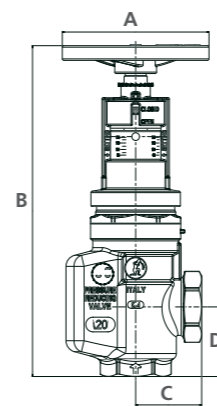

► 400lb. field adjustable automatic pressure regulating valve for use as a fire hose rack assembly valve or sprinkler control valve where pressure requires regulation.

DOUBLE FEMALE

Standard equipment:

Cast bronze valve with Female NPT inlet and outlet.  
Visual indicator.  
Red hand wheel.

CERTIFICATIONS	
CE x 1259 LISTED 12HO	

	a	b
	2 1/2"	2 1/2"

	2 1/2" x 2 1/2"
A	7 1/8"
B	17 27/32"
C	3 13/32"
D	3 3/4"

**Pressure Reducing Device Angle Valve 175 Lb. Rated**

**A156**

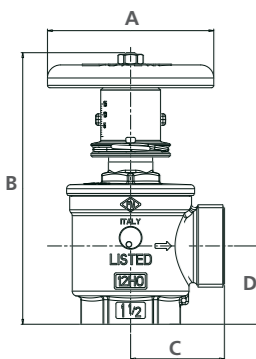

SPECIFY THREAD

► Adjustable restriction of residual pressures up to 175 lb. Locking pin device restricts full opening of valve by untrained personnel, pin may be removed by firefighters to allow full opening of valve.

FEMALE X MALE

Standard equipment:

Female NPT inlet x male hose thread outlet forged brass valve.  
Red hand wheel.

Optional Finishes:

PB  
RC  
PC

CERTIFICATIONS	
APPROVED CE x 1258 LISTED 12HO	

	a	b
	1 1/2"	1 1/2"
	2 1/2"	2 1/2"

	2 1/2" x 2 1/2"	2 1/2" x 2 1/2"
A	4 1/64"	5 1/8"
B	7 3/32"	9 31/32"
C	2 17/64"	3"
D	1 57/64"	2 41/64"

**Angle Pressure Reducing Valve**

**A202**

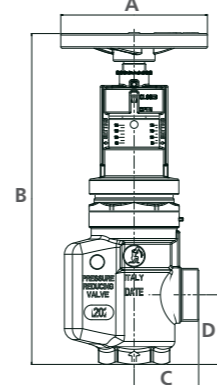

SPECIFY THREAD

► 400lb. field adjustable automatic pressure regulating valve for use as a fire hose rack assembly valve or sprinkler control valve where pressure requires regulation.

FEMALE X MALE

Standard equipment:

Cast bronze valve with Female NPT inlet x male hose thread outlet.  
Visual indicator.  
Red hand wheel.

CERTIFICATIONS	
CE x 1259 LISTED 12HO	

	a	b
	2 1/2"	2 1/2"

	2 1/2" x 2 1/2"
A	7 7/8"
B	17 27/32"
C	3 15/32"
D	3 3/4"



**FIRE PROTECTION PRODUCTS**

**Straight Pressure Reducing Valve With Checking Device**

**A203**



► 400lb. field adjustable automatic pressure regulating valve for use as a fire hose rack assembly valve or sprinkler control valve where pressure requires regulation.

DOUBLE FEMALE

Standard equipment:  
Cast bronze valve with Female NPT inlet and outlet.  
Visual indicator.  
Red hand wheel.

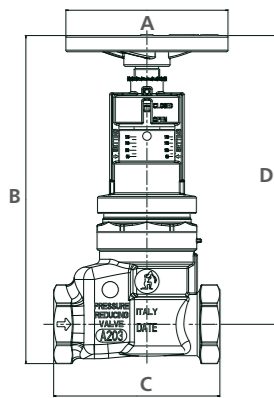

CERTIFICATIONS	
CE x 1259 LISTED 12HO	

a	b
2 1/2"	2 1/2"

**Monitor Switch Adapter**

**A170**

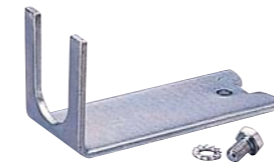

► To be installed on pressure reducing valves A201 - A202 - A203 - A204

	A170
A	3 1/4"
B	3 37/64"
C	1 57/64"

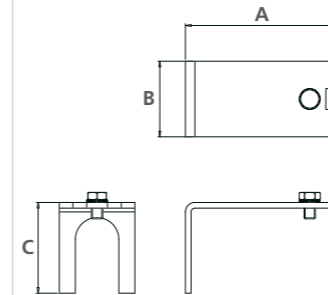

**Straight Pressure Reducing Valve**

**A204**



► 400lb. field adjustable automatic pressure regulating valve for use as a fire hose rack assembly valve or sprinkler control valve where pressure requires regulation.

FEMALE X MALE

Standard equipment:  
Cast bronze valve with Female NPT inlet x male hose thread outlet.  
Visual indicator.  
Red hand wheel.

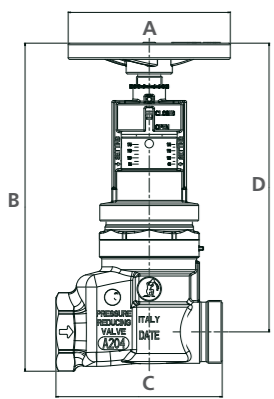

SPECIFY THREAD

CERTIFICATIONS	
CE x 1259 LISTED 12HO	

a	b
2 1/2"	2 1/2"

	2 1/2" x 2 1/2"
A	7 7/8"
B	15 15/16"
C	8"
D	14 11/16"



**FIRE PROTECTION PRODUCTS**

**Straight Single Clapper Two-Way Inlets**

**A95**

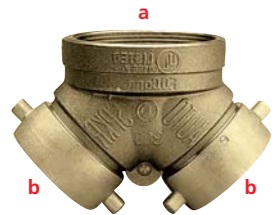

► Exposed auxiliary inlet connection with 500 G.P.M. inlet capacity to supplement fire protection water supply. Exposed design provides an economical method of satisfying Fire Dept. inlet requirements.

**Standard equipment:**  
Cast brass two-way inlet body with single swing clapper and pin or rocker lug hose thread swivel; straight NPT outlet connection.

**Branding:** "AUTO SPKR"

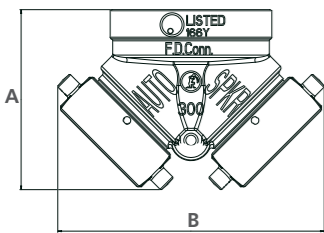

SPECIFY THREAD

CERTIFICATIONS	
APPROVED CE x 1191 LISTED 166Y	

a	b
4"	2 1/2"

	4" x 2 1/2"
A	5 33/64"
B	8 5/64"

**Straight Two-way Male Outlets**

**A97**



► Used as a standpipe roof outlet connection by the fire service. Provides 250 G.P.M. minimum per outlet. Used with straight or angle hose valves to provide water control

**Standard equipment:**  
Cast brass body with female NPT inlet and male NPT or male hose thread outlets. Straight connection.

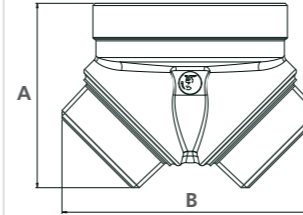

SPECIFY THREAD

a	b
4"	2 1/2"
6"	2 1/2"

	4" x 2 1/2"	6" x 2 1/2"
A	4 57/64"	5 23/32"
B	6 57/64"	8 5/8"

**90° Single Clapper Two-Way Inlets**

**A96**



► Exposed auxiliary inlet connection with 500 G.P.M. inlet capacity to supplement fire protection water supply. Exposed design provides an economical method of satisfying Fire Dept. inlet requirements.

**Standard equipment:**  
Cast brass two-way inlet body with single swing clapper and pin or rocker lug hose thread swivel; angle NPT outlet connection.

**Branding:** "AUTO SPKR"

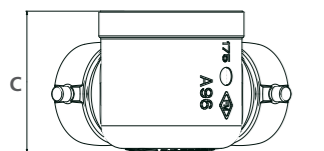
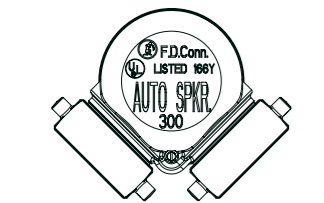

SPECIFY THREAD

CERTIFICATIONS	
CE x 1191 LISTED 166Y	

a	b
4"	2 1/2"

	4" x 2 1/2"
A	8 5/64"
B	6 11/16"
C	4 29/32"

**Straight Three-way Male Outlets**

**A97**



► Used as a standpipe roof outlet connection by the fire service. Provides 250 G.P.M. minimum per outlet. Used with straight or angle hose valves to provide water control

**Standard equipment:**  
Cast brass body with female NPT inlet and male NPT or male hose thread outlets. Straight connection.

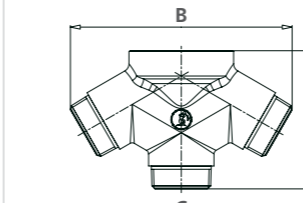

SPECIFY THREAD

a	b
4"	2 1/2"
6"	2 1/2"

	4" x 2 1/2"	6" x 2 1/2"
A	6 21/32"	6 57/64"
B	10 11/16"	10 11/16"
C	5 3/64"	7 3/32"





**FIRE PROTECTION PRODUCTS**

**90° Two-way Male Outlets**

**A98**

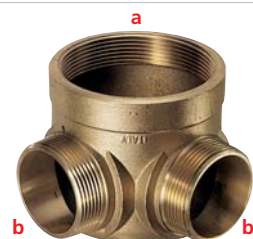

► Used as a standpipe roof outlet connection by the fire service. Provides 250 G.P.M. minimum per outlet. Used with straight or angle hose valves to provide water control

**Standard equipment:**  
Cast brass body with female NPT inlet and male NPT or male hose thread outlets.  
Straight connection.

a	b
4"	2 1/2"
6"	2 1/2"

	4" x 2 1/2"	6" x 2 1/2"
A	6 7/64"	8 9/64"
B	7 11/64"	9 1/64"
C	4 29/32"	4 33/64"

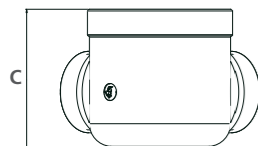
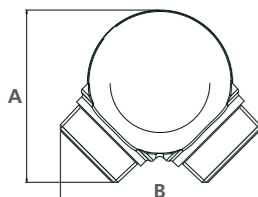

SPECIFY THREAD

**90° Three-way Male Outlets**

**A98**



► Used as a standpipe roof outlet connection by the fire service. Provides 250 G.P.M. minimum per outlet. Used with straight or angle hose valves to provide water control

**Standard equipment:**  
Cast brass body with female NPT inlet and male NPT or male hose thread outlets.  
Straight connection.

a	b
4"	2 1/2"
6"	2 1/2"

	4" x 2 1/2"	6" x 2 1/2"
A	6 15/32"	8 35/64"
B	6 21/32"	9 27/32"
C	5 3/64"	7 3/32"
D	5 21/64"	4 29/64"
E	5 55/64"	7 59/64"

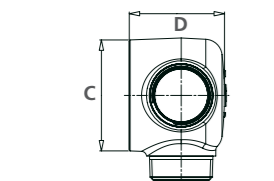
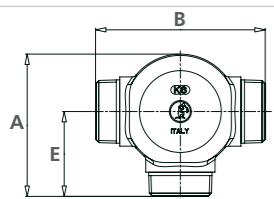

SPECIFY THREAD

**Straight Concealed Siamese**

**A101**

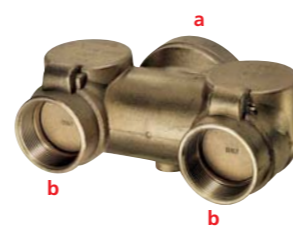

► Concealed auxiliary inlet with 500 G.P.M. inlet capacity to supplement Fire Protection water supply.

**Standard equipment:**  
Cast brass two-way inlet body with double drop clappers; NPT Threads.

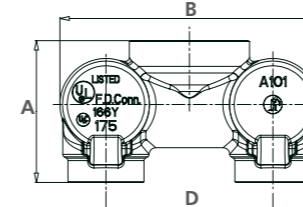
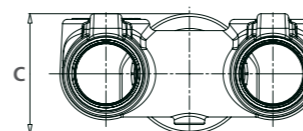

CERTIFICATIONS		
APPROVED	CE x 1191	LISTED 175

a	b
4"	2 1/2"
4"	3"
6"	2 1/2"

	4" x 2 1/2"	4" x 3"	6" x 2 1/2"
A	5 61/64"	6 31/64"	8 19/64"
B	10 55/64"	12 1/16"	11 31/64"
C	3 3/64"	5 19/64"	7 3/32"
D	7"	7 5/8"	7 5/8"

**90° Concealed Siamese**

**A102**



► Concealed auxiliary inlet with 500 G.P.M. inlet capacity to supplement Fire Protection water supply.

**Standard equipment:**  
Cast brass two-way inlet body with double drop clappers; NPT Threads.

**Note:**  
One body can serve as bottom or top feed by changing clappers.

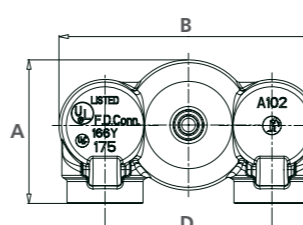
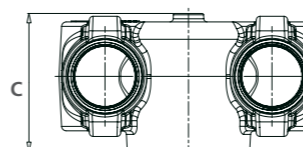

CERTIFICATIONS		
APPROVED	CE x 1191	LISTED 618R

a	b
4"	2 1/2"
4"	3"
6"	2 1/2"

	4" x 2 1/2"	4" x 3"	6" x 2 1/2"
A	6 1/64"	6 1/2"	8 39/64"
B	10 55/64"	12 1/16"	12 15/32"
C	5 25/32"	6 9/32"	6 21/64"
D	7"	7 5/8"	7 5/8"





**FIRE PROTECTION PRODUCTS**

**Straight Double Clapper Two-way Inlets**

**A105**



► Exposed auxiliary inlet connection with 500 G.P.M. inlet capacity to supplement fire protection water supply. Exposed design provides an economical method of satisfying Fire Dept. inlet requirements.

**Standard equipment:**  
Cast brass two-way inlet body with double drop clappers and pin lug hose thread swivels; straight NPT outlet connection.

**Branding:**  
A105/1 - AUTO-SPKR  
A105/2 - STANDPIPE

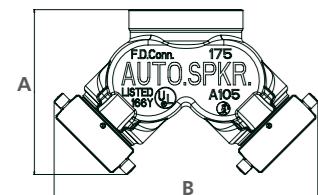

SPECIFY THREAD

CERTIFICATIONS	
APPROVED LISTED 166Y	

	a	b
	4"	2 1/2"
	4"	3"
	6"	2 1/2"
	6"	3"

	4" x 2 1/2"	4" x 3"	6" x 2 1/2"	6" x 3"
A	7 9/32"	8 1/32"	8 5/32"	8 23/32"
B	11 21/32"	12 27/32"	11 21/32"	12 7/8"

**90° Double Clapper Two-way Inlets**

**A106**

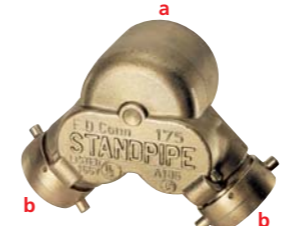

► Exposed auxiliary inlet connection with 500 G.P.M. inlet capacity to supplement fire protection water supply. Exposed design provides an economical method of satisfying Fire Dept. inlet requirements.

**Standard equipment:**  
Cast brass two-way inlet body with double drop clappers and pin lug hose thread swivels; angle NPT outlet connection.

**Branding:**  
A106/1 - AUTO-SPKR  
A106/2 - STANDPIPE

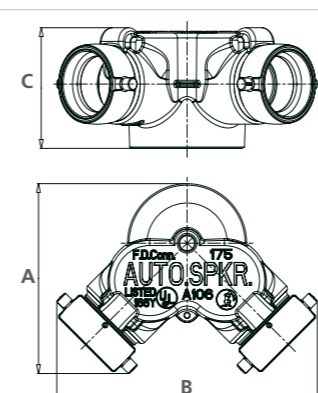

SPECIFY THREAD

CERTIFICATIONS	
APPROVED LISTED 166Y	

	a	b
	4"	2 1/2"
	4"	3"
	6"	2 1/2"
	6"	3"

	4" x 2 1/2"	4" x 3"	6" x 2 1/2"	6" x 3"
A	8 31/64"	9 3/32"	9 15/32"	10 3/32"
B	11 21/32"	12 27/32"	11 21/32"	12 7/8"
C	5 25/64"	5 21/32"	5 25/64"	5 57/64"

**Straight Triple Clapper Three-way Inlets**

**A105**



► Exposed auxiliary inlet connection with 500 G.P.M. inlet capacity to supplement fire protection water supply. Exposed design provides an economical method of satisfying Fire Dept. inlet requirements.

**Standard equipment:**  
Cast brass three-way inlet body with triple drop clappers and pin lug hose thread swivels; straight NPT outlet connection.

**Branding:**  
A105/1 - AUTO-SPKR  
A105/2 - STANDPIPE

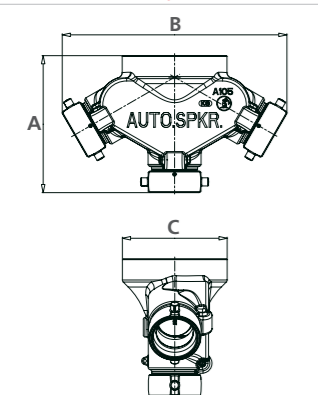

SPECIFY THREAD

	a	b
	4"	2 1/2"
	6"	2 1/2"

	4" x 2 1/2"	6" x 2 1/2"
A	9 17/64"	9 17/64"
B	15 13/64"	15 13/64"
C	7 3/32"	7 3/32"

**90° Triple Clapper Three-way Inlets**

**A106**



► Exposed auxiliary inlet connection with 500 G.P.M. inlet capacity to supplement fire protection water supply. Exposed design provides an economical method of satisfying Fire Dept. inlet requirements.

**Standard equipment:**  
Cast brass three-way inlet body with triple drop clappers and pin lug hose thread swivels; angle NPT outlet connection.

**Branding:**  
A106/1 - AUTO-SPKR  
A106/2 - STANDPIPE

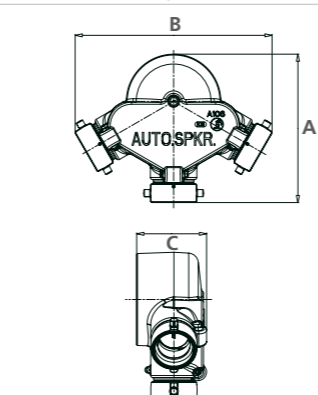

SPECIFY THREAD

	a	b
	4"	2 1/2"
	6"	2 1/2"

	4" x 2 1/2"	6" x 2 1/2"
A	11 29/64"	11 29/64"
B	15 13/64"	15 13/64"
C	5 25/64"	5 25/64"



**FIRE PROTECTION PRODUCTS**

Plate

**A103**

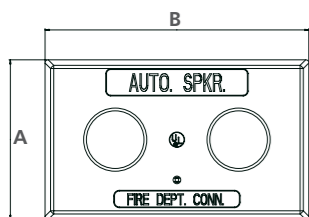

► Suitable to A101 -A102

**Standard equipment:**  
Cast brass two-way inlet body with double drop clappers.

**Branding:**  
A103/1 - AUTO-SPKR  
A103/2 - STANDPIPE  
A103/3- AUTO-SPKR STANDPIPE  
A103/4 - WALL HYDRANT  
A103/5 - PLAIN BUT UL EMBLEM

**Optional Finishes:**  
PB  
PC

A103	
A	9 3/32"
B	15 3/64"

Leader Line Dual Ball Valve

**A99**

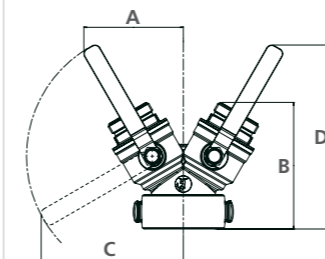
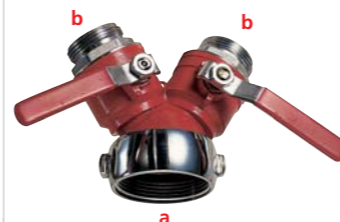

SPECIFY THREAD

► Chrome plated furnished with rocker lug swivels.

**Standard equipment:**  
Red painted.

a	b
2 1/2"	1 1/2"

	2 1/2" x 1 1/2"
A	4 13/32"
B	5 35/64"
C	6 7/64"
D	8 15/64"

Hose Rack Mounting Nipple

**A65**

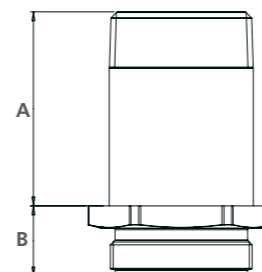

SPECIFY THREAD

► Used to mount or hold rack.

**Standard equipment:**  
Forged brass finish valve with male NPT inlet x male hose thread outlet.

**Optional Finishes:**  
RB  
PB  
RC  
PC

a	b
1 1/2"	1 1/2"
2 1/2"	2 1/2"

	1 1/2" x 1 1/2"	2 1/2" x 2 1/2"
A	2 9/16"	3 7/64"
B	59/64"	1 11/32"



**FIRE PROTECTION PRODUCTS**

**Female To Male Reducer**

**A75**



► Used to reduce or change Fire Hose threads.

**Standard equipment:**  
Forged brass with pin or rocker lugs with female thread larger than male thread.

a	b
2 1/2"	3/4"
2 1/2"	1 1/2"
2 1/2"	2"

	2 1/2" x 3/4"	2 1/2" x 1 1/2"	2 1/2" x 2"
<b>A</b>	1 1/16"	1 1/16"	1 1/16"
<b>B</b>	49/64"	5/8"	49/64"

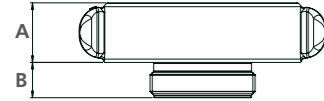

SPECIFY THREAD

**Male Open Snoot**

**A91**



► Used to connect fire hose standpipe or sprinkler system.

FEMALE (SWIVEL) x MALE

**Standard equipment:**  
Forged brass with female (pin lug swivel) hose inlet x male NPT outlet.

Swivel furnished with pin or rocker lugs.

**Optional Finishes:**

- PB
- RC
- PC

a	b
1 1/2"	1 1/2"
2 1/2"	2"
2 1/2"	2 1/2"
2 1/2"	3"

	1 1/2" x 1 1/2"	2 1/2" x 2"	2 1/2" x 2 1/2"	2 1/2" x 3"
<b>A</b>	8 5/8"	10 57/64"	10 57/64"	10 31/32"
<b>B</b>	13/16"	51/64"	1 15/64"	1 13/64"

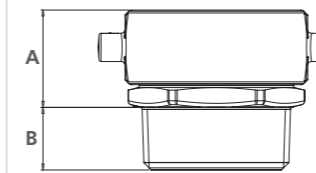

SPECIFY THREAD

**Female Open Snoot**

**A90**



► Used to connect fire hose standpipe or sprinkler system.

FEMALE (SWIVEL) x FEMALE

**Standard equipment:**  
Polish brass with female (pin lug swivel) hose inlet x female NPT outlet.

Swivel furnished with pin or rocker lugs.

**Optional Finishes:**

- PC

a	b
2 1/2"	2 1/2"
2 1/2"	3"

	2 1/2" x 2 1/2"	2" 1/2 x 3"
<b>A</b>	1 7/8"	2 1/64"
<b>B</b>	13/16"	1 1/32"

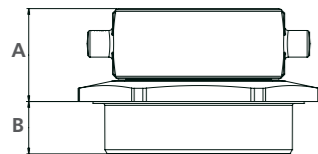

SPECIFY THREAD

**Female Open Snoot Base**

**A83**

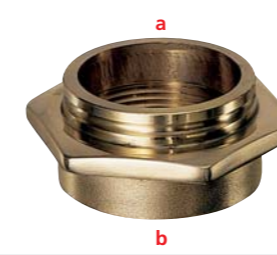

► To be used on any thread swivel A89

MALE x FEMALE

**Standard equipment:**  
Forged brass with female hose inlet x female NPT outlet.

a	b
2 1/2"	2 1/2"
2 1/2"	3"

	2 1/2" x 2 1/2"	2 1/2" x 3"
<b>A</b>	1 3/4"	2 5/64"

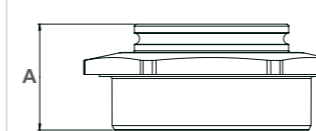

SPECIFY THREAD





**Male Open Snoot Base**

**A87**



► To be used on any thread swivel A89

MALE x FEMALE

Standard equipment:  
Forged brass with female hose inlet  
x male NPT outlet.

a	b
2 1/2"	2"
2 1/2"	2 1/2"
2 1/2"	3"

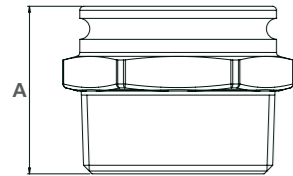

**Male To Male Adapter**

**A88**

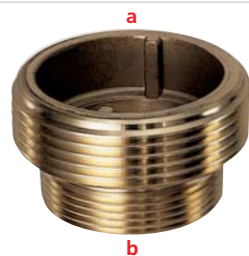

► To convert NPT female thread to male hose thread.

a	b
2 1/2"	2 1/2"
2 1/2"	3"

	2 1/2" x 2 1/2"	2 1/2" x 3"
A	1 29/64"	1 31/32"

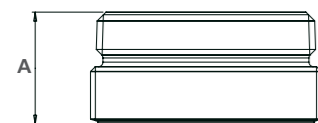

SPECIFY THREAD

**Male To Groove Adapter**

**A88G**



► To convert NPT female thread to Groove thread.

a	b
2 1/2"	2 1/2"
4"	4"

	2 1/2" x 2 1/2"	4" x 4"
A	2 3/64"	2 3/64"



**Swivel**

**A89**



► Available with pin or rocker lugs.

	2 1/2"	3"
A	4 1/2"	5 15/64"
B	1 29/64"	1 1/2"

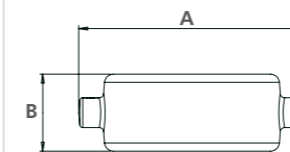

SPECIFY THREAD



**FIRE PROTECTION PRODUCTS**

**Male To Male Adapter**

**A92**



► To adapt or reduce threads, and change NPT pipe thread to hose thread.

MALE x MALE

Standard equipment:  
Brass hexagon type.

a	b
1 1/2"	1 1/2"
2 1/2"	2"
2 1/2"	2 1/2"
2 1/2"	3"

	1 1/2" x 1 1/2"	2 1/2" x 2"	2 1/2" x 2 1/2"	2 1/2" x 3"
A	61/64"	1 7/16"	1 7/16"	1 25/64"
B	13/16"	13/16"	1 15/64"	1 19/64"

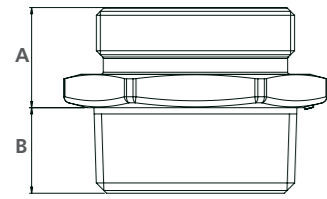

SPECIFY THREAD

**Female To Female Adapter**

**A94**

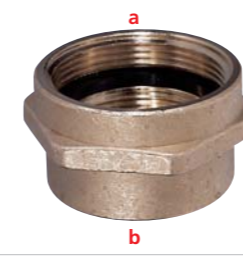

► For thread conversion

FEMALE x FEMALE

Standard equipment:  
Brass hexagon type.

a	b
1 1/2"	1 1/2"
2 1/2"	2 1/2"

	1 1/2" x 1 1/2"	2 1/2" x 2 1/2"
A	1 27/64"	2 3/64"

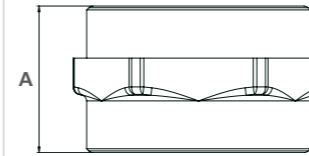

SPECIFY THREAD

**Female To Male Adapter**

**A93**



► To adapt or reduce threads or change NPT pipe thread to hose thread.

FEMALE x MALE

Standard equipment:  
Brass hexagon type.

a	b
1 1/2"	1 1/2"
2 1/2"	2"
2 1/2"	2 1/2"

	1 1/2" x 1 1/2"	2 1/2" x 2"	2 1/2" x 2 1/2"
A	51/64"	1 3/64"	1 9/64"
B	39/64"	53/64"	1"

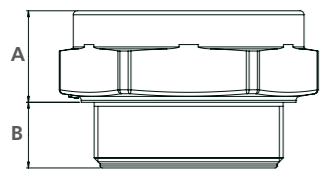

SPECIFY THREAD

**Bushing**

**A104**



► To change 6" to 8" or 4" to 6" thread.

FEMALE x MALE

Standard equipment:  
Brass bushing with female thread on one end and male on other end; NPT Threads.

a	b
6"	4"
8"	6"

	6" x 4"	8" x 6"
A	2 25/64"	3 5/32"





**FIRE PROTECTION PRODUCTS**

**Female Check Snoot**

**A90C**



► To connect fire hose on multiple inlet Fire Dept. connections. Checks excess backflow of water.

FEMALE (SWIVEL) x FEMALE

**Standard equipment:**  
Cast brass with female (swivel) hose inlet x female NPT outlet and checking device.

Swivel furnished with pin or rocker lugs.

**Optional Finishes:**  
PB  
PC

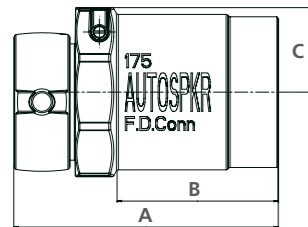

SPECIFY THREAD

CERTIFICATIONS	

a	b
2 1/2"	3"

2 1/2" x 3"	
A	6 57/64"
B	4 11/64"
C	2 21/64"

**Male Check Snoot**

**A91C**



► To connect fire hose on multiple inlet Fire Dept. connections. Checks excess backflow of water.

FEMALE (SWIVEL) x MALE

**Standard equipment:**  
Cast brass with female (swivel) hose inlet x female NPT outlet and checking device.

Swivel furnished with pin or rocker lugs.

**Optional Finishes:**  
PB  
PC

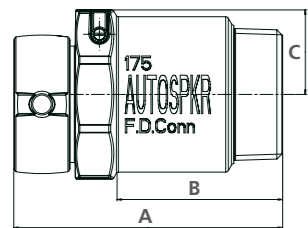

SPECIFY THREAD

CERTIFICATIONS	

a	b
2 1/2"	3"

2 1/2" x 3"	
A	7 3/32"
B	4 9/32"
C	2 21/64"

**Flush Fire Dept. Inlet Connections - Clapper Snoot Type**

**A111 End Outlet Body**

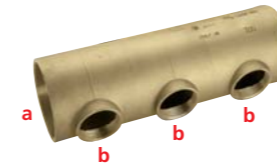

► Used as an auxiliary inlet connection to supplement the fire protection water supply.

Available with 3, 4, 6 outlets;  
NPT Threads.

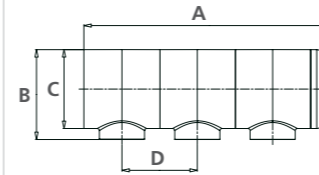

CERTIFICATIONS	

a	b
6"	3"
8"	3"

	6" x 3" /3	6" x 3" /4	6" x 3" /6
A	23 23/64"	30 23/64"	44 23/64"
B	8 11/32"	8 11/32"	8 11/32"
C	7 21/64"	7 21/64"	7 21/64"
D	7"	7"	7"

**A112 Back Outlet Body**

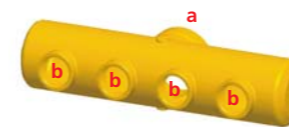

► Used as an auxiliary inlet connection to supplement the fire protection water supply.

Available with 4, 6 outlets;  
NPT Threads.

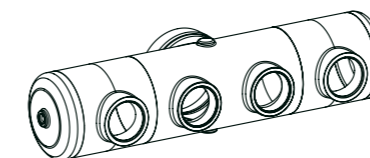
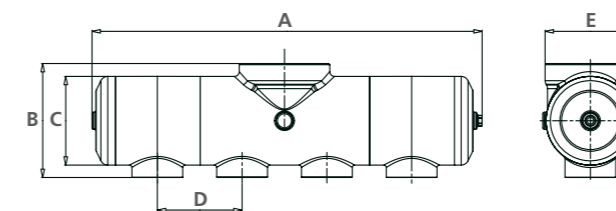

a	b
6"	3"
8"	3"

	6" x 3" /4	6" x 3" /6
A	32 7/32"	46 7/32"
B	9 13/32"	9 13/32"
C	7 21/64"	7 21/64"
D	7"	7"
E	7 31/64"	7 31/64"





**FIRE PROTECTION PRODUCTS**

**A113 Angle Outlet Body**

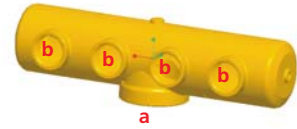

► Used as an auxiliary inlet connection to supplement the fire protection water supply.

Available with 4, 6 outlets; NPT Threads.

a	b
6"	3"
8"	3"

	6" x 3/4"	6" x 3/6"
A	32 7/32"	46 7/32"
B	8 25/32"	8 25/32"
C	7 21/64"	7 21/64"
D	7"	7"
E	7 31/64"	7 31/64"
F	8 13/16"	8 13/16"

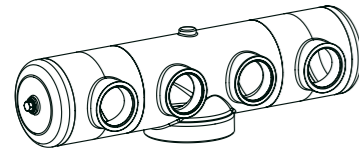
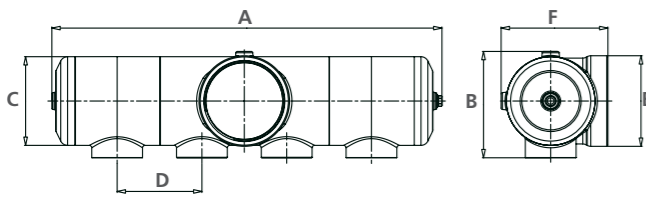

**A115 Angle Outlet Body**

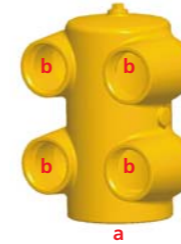

► Used as an auxiliary inlet connection to supplement the fire protection water supply.

Available with NPT Threads.

a	b
6"	3"
8"	3"

	6" x 3"
A	15 5/16"
B	8 55/64"
C	7 31/64"
D	7"
E	11 29/32"

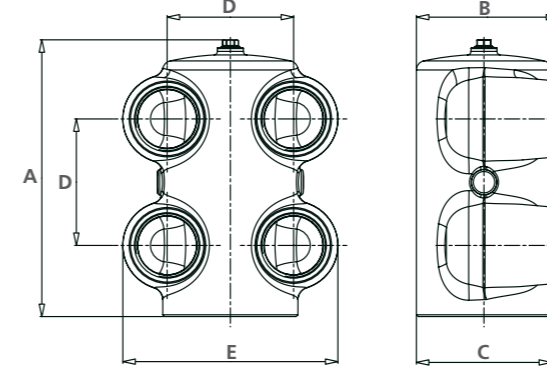

**Flush Fire Dept. Inlet Connections - Clapper Snoot Type Four-way Square Body**

**A114 Back Outlet Body**

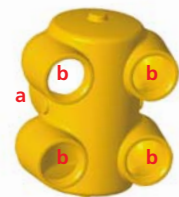

► Used as an auxiliary inlet connection to supplement the fire protection water supply.

Available with NPT Threads.

a	b
6"	3"
8"	3"

	6" x 3"
A	15 13/64"
B	8 55/64"
C	7 31/64"
D	7"
E	11 29/32"

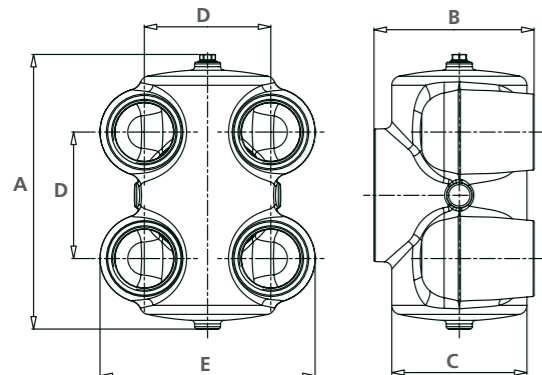

**Flush Fire Dept. Inlet Connections - Clapper Body Type**

**A121 End Outlet Body**

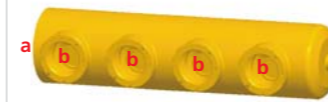

► Used as an auxiliary inlet connection to supplement the fire protection water supply. Drop clappers provide unobstructed waterway.

Supplied with HL configuration Available with 3, 4, 6 outlets; NPT Threads.

Standard version "Horizontal Left"

a	b
6"	3"
8"	3"

	6" x 3" /3	6" x 3" /4	6" x 3" /6
A	23 23/64"	30 23/64"	44 23/64"
B	8 1/4"	8 1/4"	8 1/4"
C	7 21/64"	7 21/64"	7 21/64"
D	7"	7"	7"

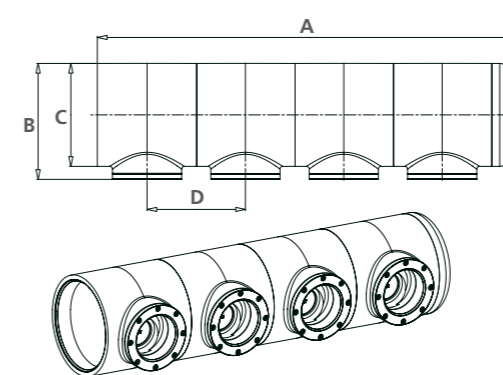



**FIRE PROTECTION PRODUCTS**

Flush Fire Dept. Inlet Connections - Clapper Body Type Four-way Square Body

**A122 Back Outlet Body**

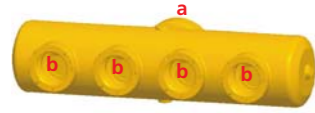

► Used as an auxiliary inlet connection to supplement the fire protection water supply. Drop clappers provide unobstructed waterway.

Supplied with H configuration  
Available with 4, 6 outlets;  
NPT Threads.

Standard version "Horizontal"

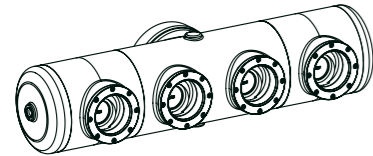
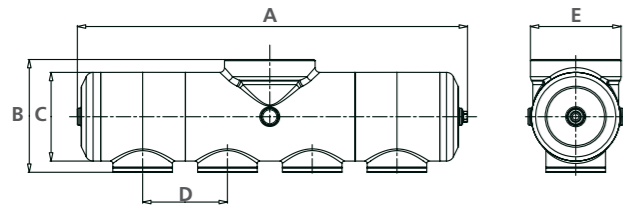

a	b
6"	3"
8"	3"

	6" x 3" /4	6" x 3" /6
A	32 7/32"	46 7/32"
B	9 5/16"	9 5/16"
C	7 21/64"	7 21/64"
D	7"	7"
E	7 31/64"	7 31/64"

**A123 Angle Outlet Body**

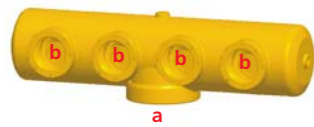

► Used as an auxiliary inlet connection to supplement the fire protection water supply. Drop clappers provide unobstructed waterway.

Supplied with HB configuration  
Available with 4, 6 outlets;  
NPT Threads.

Standard version "Horizontal Bottom"

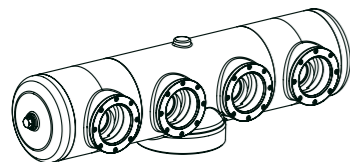
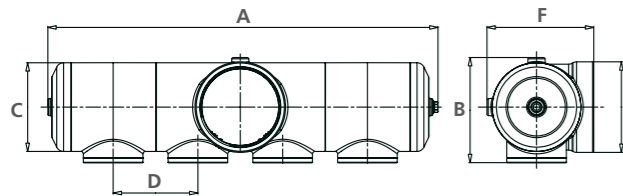

a	b
6"	3"
8"	3"

	6" x 3" /4	6" x 3" /6
A	32 7/32"	46 7/32"
B	8 11/16"	8 11/16"
C	7 21/64"	7 21/64"
D	7"	7"
E	7 31/64"	7 31/64"
F	8 13/16"	8 13/16"

**A124 Back Outlet Body**

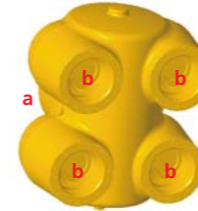

► Used as an auxiliary inlet connection to supplement the fire protection water supply. Drop clappers provide unobstructed waterway.

Available with NPT Threads.

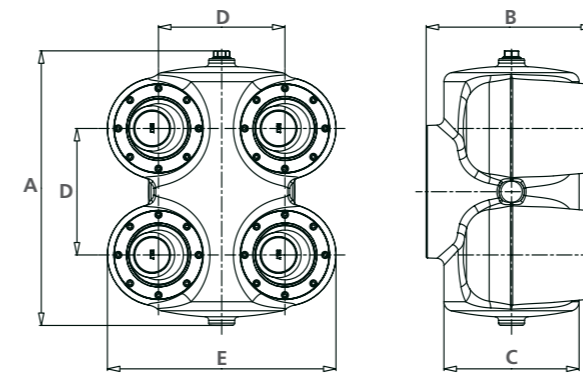

a	b
6"	3"
8"	3"

	6" x 3"
A	15 13/64"
B	9 1/4"
C	7 31/64"
D	7"
E	12 21/32"

**A125 Angle Outlet Body**



► Used as an auxiliary inlet connection to supplement the fire protection water supply. Drop clappers provide unobstructed waterway.

Supplied with B configuration;  
NPT Threads.

Standard version "Bottom"

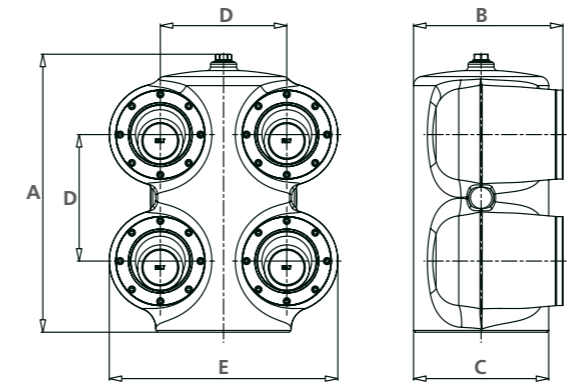

a	b
6"	3"
8"	3"

	6" x 3"
A	15 25/64"
B	8 17/64"
C	7 31/64"
D	7"
E	12 21/32"



**FIRE PROTECTION PRODUCTS**

**Single Inlet Connection**

**A190T**

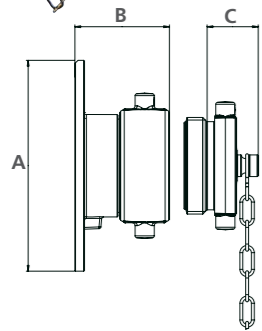
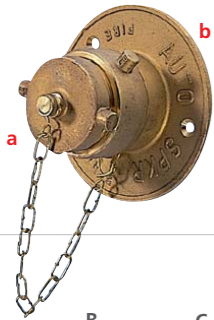

SPECIFY THREAD

► For residential sprinkler systems. Available with NST or NPSH thread.

A190: no plug and chain.

CERTIFICATIONS



LISTED 166Y

a	b
1 1/2"	1 1/2"

	1 1/2" x 1 1/2"
A	4 11/32"
B	1 61/64"
C	29/32"

**Cap And Chain**

**A80**

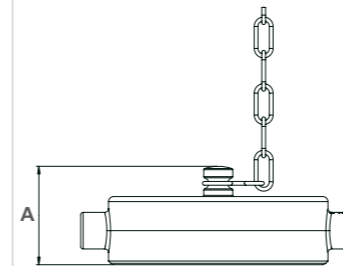
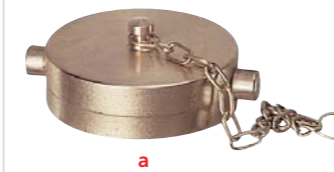

SPECIFY THREAD

► To cover and protect male outlet threads on valves and hydrants. Prevents entry of foreign material.

Standard equipment: Forged brass with chain.

Available with pin or rocker lugs.

Optional Finishes:

- PB
- RC
- PC

	1 1/2"	2 1/2"	3"
A	1 15/64"	1 35/64"	1 23/32"

**Swing Check Valve**

**A140**

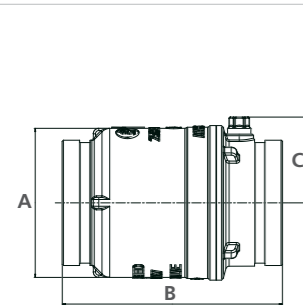

SPECIFY THREAD

► For sprinkler and standpipe systems.

Available with the following threads:  
4" NPT inlet x Groove outlet;  
4" NPT Male inlet x NPT Female outlet;  
4" Groove inlet and outlet.

4" MALE x FEMALE is FM approved as "Anti-water Hammer check valve"

CERTIFICATIONS



APPROVED CE x 1260 LISTED 97X7

a	b
4"	4"

	4"
A	5 23/64"
B	7 29/32"
C	3"

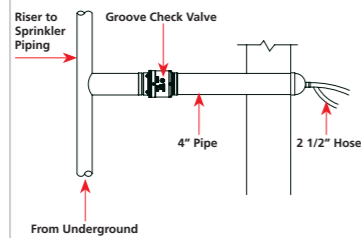

**Plug And Chain**

**A81**

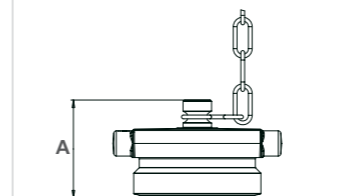

SPECIFY THREAD

► For Fire Dept. inlet connections. Prevents entry of foreign matter and protects female threads.

Standard equipment: Forged brass plug with male hose thread and attached chain.

Available with pin or rocker lugs.

Optional Finishes:

- PB
- RC
- PC

	1 1/2"	2 1/2"	3"
A	1 35/64"	2 7/32"	2 3/8"





**FIRE PROTECTION PRODUCTS**

Cap And Chain In Plastic (Abs) Red Color

**A80P**



► To cover and protect male outlet threads on valves and hydrants. Prevents entry of foreign material.

Standard equipment:  
ABS - with chain.

Available with rocker lugs.

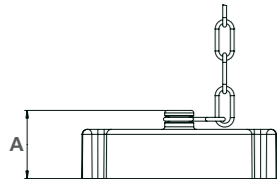

SPECIFY THREAD

	1 1/2"	2 1/2"
A	1 15/64"	1 35/64"

Cap And Chain In Plastic (Abs) Chrome Plated

**A80PC**



► To cover and protect male outlet threads on valves and hydrants. Prevents entry of foreign material.

Standard equipment:  
ABS - with chain.

Available with rocker lugs.

Optional Finishes:  
PC

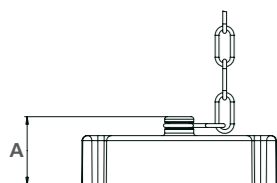

SPECIFY THREAD

	2 1/2"	2 1/2"
A	1 15/64"	1 35/64"

Double Jacket Brass Coupling

**A70**



► Pin lug coupling for use with single or double jacket linen hose.

Standard equipment:  
Forged brass finish, 1 1/2" or 2 1/2" sizes, with swivels washer.

Coupling Jacket:  
S- Single  
D- Double  
L- Linen

Optional Finishes:  
PB  
RC  
PC

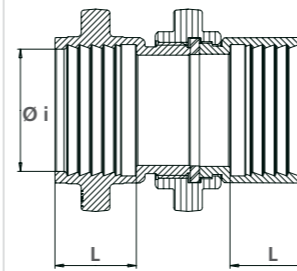

SPECIFY TYPE

Type	Lenght	Thread	Øi	Jacket
C0	28,5	1 1/2" NST	1 11/16"	L
D0	28,5	1 1/2" NPSH	1 11/16"	L
E	31,8	1 1/2" NST	1 3/4"	S
F	31,8	1 1/2" NPSH	1 3/4"	S
P	31,8	1 1/2" NST	1 13/16"	S
R	31,8	1 1/2" NPSH	1 13/16"	D
E0	38,2	1 1/2" NST	1 3/4"	D
F0	38,2	1 1/2" NPSH	1 3/4"	D
T0	38,2	1 1/2" NST	1 7/8"	D
T	38,2	1 1/2" NST	1 15/16"	D
A1	38,8	2 1/2" NST	2 11/16"	L
C1	38,8	2 1/2" NST	2 11/16"	S
B1	38,8	2 1/2" NYFD	2 11/16"	L
B2	38,8	2 1/2" NYC	2 11/16"	L
L1	38,8	2 1/2" NYFD	2 11/16"	S
D1	38,8	2 1/2" NST	2 13/16"	S
D2C	38,8	2 1/2" NYC	2 13/16"	S
D2D	38,8	2 1/2" NYFD	2 13/16"	S
F1	38,8	2 1/2" NPSH	2 13/16"	S
S1	38,8	2 1/2" NST	2 27/32"	S
U1	38,8	2 1/2" NPSH	2 27/32"	S
S2	38,8	2 1/2" NYC	2 27/32"	S
M1	45,2	2 1/2" NST	3"	D
O1	45,2	2 1/2" NPSH	3"	D
AA	31,8	2" NST	2 19/64"	S
BB	31,8	2" NPSH	2 19/64"	S
CC	38,2	2" NST	2 35/64"	D
DD	38,2	2" NPSH	2 35/64"	D



**FIRE PROTECTION PRODUCTS**

**A70**



► Rocker lug coupling for use with single or double jacket linen hose.

Standard equipment:  
Forged brass finish, 1 1/2" or 2 1/2" sizes, with swivels washer.

Coupling Jacket:  
S- Single  
D- Double  
L- Linen

Optional Finishes:  
PB  
RC  
PC

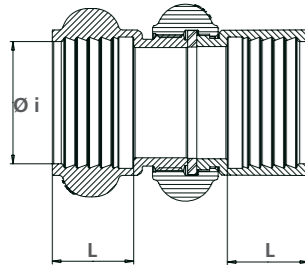

SPECIFY TYPE

Type	Lenght	Thread	Øi	Jacket
A0	28,5	1 1/2" NST	1 11/16"	L
B0	28,5	1 1/2" NPSH	1 11/16"	L
M	31,8	1 1/2" NST	1 3/4"	S
O	31,8	1 1/2" NPSH	1 3/4"	S
Q	31,8	1 1/2" NST	1 13/16"	S
S	31,8	1 1/2" NPSH	1 13/16"	S
U0	38,2	1 1/2" NST	1 7/8"	D
Z0	38,2	1 1/2" NPSH	1 7/8"	D
U	38,2	1 1/2" NST	1 15/16"	D
Z	38,2	1 1/2" NPSH	1 15/16"	D
M0	38,2	1 1/2" NST	1 3/4"	D
O0	38,2	1 1/2" NPSH	1 3/4"	D
E1	38,8	2 1/2" NST	2 13/16"	S
G1	38,8	2 1/2" NPSH	2 13/16"	S
T1	38,8	2 1/2" NST	2 27/32"	S
V1	38,8	2 1/2" NPSH	2 27/32"	S
T2	38,8	2 1/2" NYC	2 27/32"	S
A3	38,8	2 1/2" CSA	2 3/4"	S
C3	38,8	2 1/2" QST	2 3/4"	S
E3	38,8	2 1/2" BCT	2 3/4"	S
F3	38,8	2 1/2" WCT	2 3/4"	S
D3	38,8	2 1/2" NST	2 3/4"	S
H3	38,8	2 1/2" NSST	2 3/4"	S
N1	38,8	2 1/2" NST	3"	D
P1	45,2	2 1/2" NPSH	3"	D
N2	45,2	2 1/2" NYC	3"	D
B3	45,2	2" CSA	3"	D
G3	45,2	2" QST	3"	D

**A70**



► Pin or rocker lug coupling for use with single or double jacket linen hose.

Standard equipment:  
Forged brass finish, 1 1/2" or 2 1/2" sizes and swivel washer.

Coupling Jacket:  
S- Single  
L- Linen

Optional Finishes:  
PB  
RC  
PC

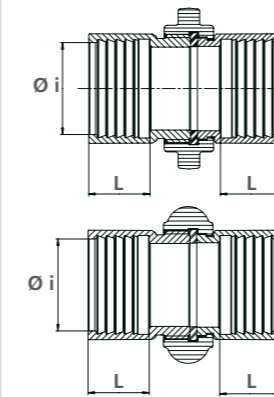

SPECIFY TYPE

Type	Lenght	Thread	Øi	Jacket
A	28,5	1 1/2" NST	1 11/16"	L
A2	28,5	1 1/2" CHT	1 11/16"	L
B	28,5	1 1/2" NPSH	1 11/16"	L
L	28,5	1 1/2" NYSH	1 11/16"	L
N	28,5	1 1/2" PCT	1 11/16"	L
C	28,5	1 1/2" NST	1 3/4"	S
D	28,5	1 1/2" NPSH	1 3/4"	S

Type	Lenght	Thread	Øi	Jacket
G	28,5	1 1/2" NST	1 11/16"	L
I	28,5	1 1/2" NPSH	1 11/16"	L
H	28,5	1 1/2" NST	1 3/4"	L

**Forestry Coupling**

**A71**



► Standard equipment:  
Forged brass external long quick connect coupling for forestry fire hose.

Type	1 1/2"
A	2 49/64"
B	1 13/16"
C	1 9/32"

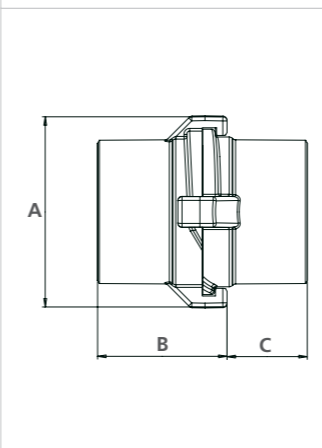



**FIRE PROTECTION PRODUCTS**

**Adjustable Fog Nozzle**

**A7A**



► For Hose Rack.

**Standard equipment:**  
Forged brass finished nozzle with adjustable fog, straight-stream and shut-off feature.

**Optional Finishes:**  
PB  
RC  
PC

CERTIFICATIONS	
APPROVED	CE x 1256 LISTED 647X

	1 1/2"
A	3 13/16"

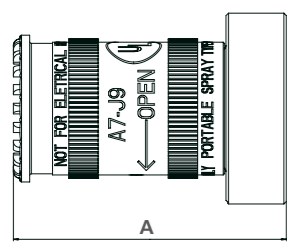

SPECIFY THREAD

**Adjustable Fog Nozzle With Bumper To Protect Nozzle**

**A7B storz**



► For Industrial Application storz connection

**Standard equipment:**  
Forged brass finished nozzle with adjustable fog, straight-stream and shut-off feature.

	1 1/2"	2 1/2"
A	5 19/32"	6 7/64"

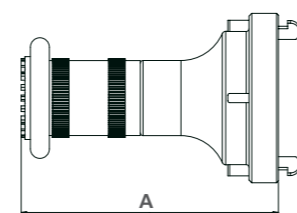

SPECIFY THREAD

**Adjustable Fog Nozzle With Bumper To Protect Nozzle**

**A7B**



► For Industrial Application.

**Standard equipment:**  
Forged brass finished nozzle with adjustable fog, straight-stream and shut-off feature.

**Optional Finishes:**  
PB  
PC

CERTIFICATIONS	
APPROVED	CE x 1260 LISTED 97X7

	1 1/2"	2 1/2"
A	3 13/16"	5 9/16"

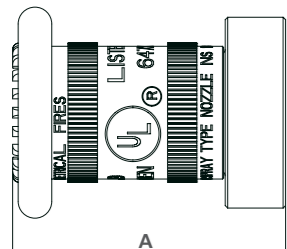

SPECIFY THREAD

**Plastic Adjustable Fog Nozzle With Bumper**

**A7BP**



► For Residential Application

**Standard equipment:**  
Nozzle with adjustable fog, straight-stream and shut-off feature.

CERTIFICATIONS	
APPROVED	CE x 589 LISTED 647X

	A
1 1/2"	4 37/64"

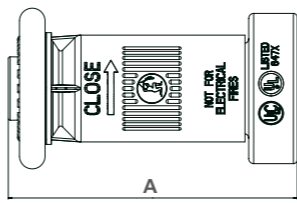

SPECIFY THREAD



**FIRE PROTECTION PRODUCTS**

**Automatic Ball Drip**

**A58**



► To drain low point of system between swing check valve and Fire Dept. connection. Automatically seals under pressure. Must be installed in vertical position only.

MALE x MALE

Standard equipment: Cast brass straight connection male NPT both.

a	b
1/2"	1/2"
3/4"	3/4"

	1/2"	3/4"
A	2 11/16"	2 11/16"

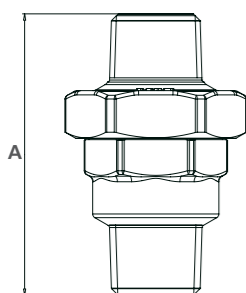

**Line-tester**

**A59**



► For installing the last sprinkler head on system branch lines, controls water flow for flushing or testing of the system.

Available with NPT Threads.

CERTIFICATIONS

APPROVED LISTED 166Y

a	b	c
1"	1"	1/2"

	1" x 1"
A	1 11/32"
B	2 3/16"
C	4"
D	1 1/2"
E	1 9/32"

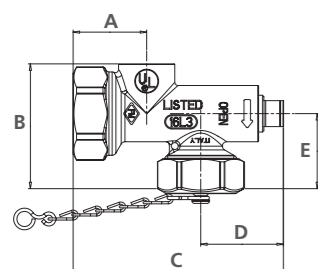

**Brass Automatic Drain Valve**

**A91AD**



► Used to prevent water damage to hose due to valve leakage

Standard equipment: Cast brass female pin lug swivel hose thread drain valve with ball seal, activated at 3 psi.

a&b = NST Threads

a	b
1 1/2"	1 1/2"

	1 1/2"
A	4 53/64"
B	4 55/64"
C	2 61/64"
D	2 1/8"

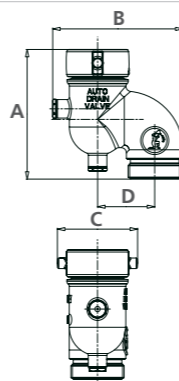

SPECIFY THREAD

**Full Port Ball Valve**

**R910**



► FEMALE x FEMALE

Standard equipment: Female NPT inlet and outlet, forged brass body, chrome plated ball with teflon seats.

CERTIFICATIONS

APPROVED LISTED 757X

a/b	PORT	A	B	C	D	H
1/2"	19/32"	2 7/32"	1 7/16"	3 3/64"	2 5/64"	63/64"
3/4"	51/64"	2 15/32"	1 29/32"	3 3/4"	2 23/32"	1 7/32"
1"	63/64"	3"	2 1/16"	3 3/4"	3 1/32"	1 9/16"
1 1/4"	1 17/64"	3 13/32"	2 1/4"	3 3/4"	3 13/32"	1 55/64"
1 1/2"	1 37/64"	3 51/64"	2 49/64"	5 3/8"	4 15/64"	2 1/8"
2"	1 31/32"	4 23/64"	3 5/64"	5 3/8"	4 55/64"	2 5/8"
2 1/2"	2 1/2"	6 1/64"	4 23/64"	7 11/32"	6 21/32"	3 15/64"
3"	3"	6 13/16"	7 31/64"	7 11/32"	7 13/32"	3 25/32"
4"	4"	8 17/32"	6 1/64"	10 7/64"	9 31/64"	4 31/32"

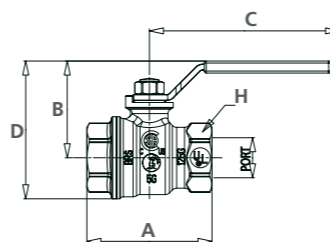





## FIRE PROTECTION PRODUCTS

## Test And Drain Valve

## A61

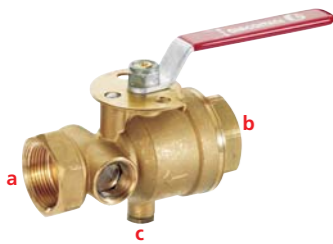

▶ FEMALE x FEMALE

Standard equipment:  
Female NPT inlet and outlet, forged  
brass body, brass finish ball  
with teflon seats.

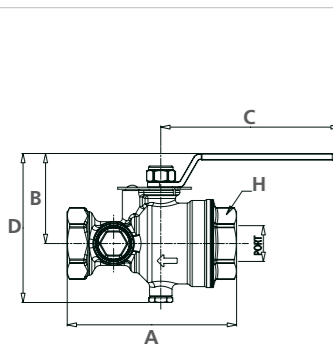

## CERTIFICATIONS



APPROVED LISTED 36Y7

a/b (Orifice)	c (plug)	PORT	A	B	C	D	H
1" (1/2")	1/4"	1 1/16"	5 1/32"	2 43/64"	5 11/32"	4 27/64"	1 57/64"
1" (17/32")	1/4"	1 1/16"	5 1/32"	2 43/64"	5 11/32"	4 27/64"	1 57/64"
1 1/4" (1/2")	1/4"	1 1/16"	5 1/32"	2 43/64"	5 11/32"	4 27/64"	1 57/64"
1 1/4" (17/32")	1/4"	1 1/16"	5 1/32"	2 43/64"	5 11/32"	4 27/64"	1 57/64"

Fig.	Size	Q.ty x Carton
A7A	1 1/2"	20
A7B	1 1/2"	20
A7B	2 1/2"	20
A7P	1 1/2"	20
A50	1 1/2" X 1 1/2"	12
A51	1 1/2" X 1 1/2"	12
A53	2 1/2" X 2 1/2"	6
A53	3" X 1 1/2"	6
A53G	2 1/2" X 2 1/2"	6
A55	1 1/2" X 1 1/2"	12
A55	2 1/2" X 2 1/2"	6
A56	1 1/2" X 1 1/2"	12
A56	2 1/2" X 2 1/2"	6
A58	1/2" X 1/2"	100
A58	3/4" X 3/4"	100
A59	1" X 1"	50
A61	1"	5
A61	1" X 1/4"	5
A65	1 1/2" X 1 1/2"	25
A65	2 1/2" X 2 1/2"	10
A70	1 1/2"	25
A70	2 1/2"	10
A71	1 1/2"	25
A75	2 1/2" X 3/4"	50
A75	2 1/2" X 1 1/2"	50
A75	2 1/2" X 2"	50
A80	1 1/2"	100
A80	2 1/2"	50
A80	3"	20
A80P	1 1/2"	100
A80P	2 1/2"	50
A80PC	1 1/2"	100
A80PC	2 1/2"	50
A81	1 1/2"	50
A81	2 1/2"	20
A81	3"	
A83	2 1/2" X 2 1/2"	25
A83	2 1/2" X 3"	25
A85	2 1/2" X 2 1/2"	4
A86	2 1/2" X 2 1/2"	4
A87	2 1/2" X 2"	25
A87	2 1/2" X 2 1/2"	25

Fig.	Size	Q.ty x Carton
A88	2 1/2" X 2 1/2"	20
A88	2 1/2" X 3"	20
A88G	2 1/2"	20
A88G	4"	15
A89G	2 1/2"	25
A90	2 1/2" X 2 1/2"	10
A90	2 1/2" X 3"	10
A90C	2 1/2" X 3"	10
A91	1 1/2" X 1 1/2"	50
A91	2 1/2" X 2"	10
A91	2 1/2" X 2 1/2"	10
A91	2 1/2" X 3"	10
A91AD	1 1/2" X 1 1/2"	
A91C	2 1/2" X 3"	5
A92	1 1/2" X 1 1/2"	50
A92	2 1/2" X 2"	20
A92	2 1/2" X 2 1/2"	20
A92	2 1/2" X 3"	20
A93	1 1/2" X 1 1/2"	50
A93	2 1/2" X 2"	20
A93	2 1/2" X 2 1/2"	20
A94	1 1/2" X 1 1/2"	50
A94	2 1/2" X 2 1/2"	25
A95	4" X 2 1/2"	8
A96	4" X 2 1/2"	8
A97	4" X 2 1/2"	10
A97	6" X 2 1/2"	
A97 Three-way	4" X 2 1/2"	
A97 Three-way	6" X 2 1/2"	
A98	4" X 2 1/2"	10
A98	6" X 2 1/2"	
A98 Three-way	4" X 2 1/2"	
A98 Three-way	6" X 2 1/2"	
A99	2 1/2" X 1 1/2"	10
A101	4" X 2 1/2"	4
A101	4" X 3"	1
A101	6" X 2 1/2"	
A102	4" X 2 1/2"	4
A102	4" X 3"	1
A102	6" X 2 1/2"	
A103		5
A104	6" X 4"	20

Fig.	Size	Q.ty x Carton
A105	4" X 2 1/2"	4
A105	4" X 3"	1
A105	6" X 2 1/2"	1
A105	6" X 3"	
A105 Three-way	4" X 2 1/2"	
A105 Three-way	6" X 2 1/2"	
A106	4" X 2 1/2"	4
A106	4" X 3"	1
A106	6" X 2 1/2"	1
A106	6" X 3"	
A106 Three-way	4" X 2 1/2"	
A106 Three-way	6" X 2 1/2"	
A111	6" X 3"	1
A111	8" X 3"	1
A112	6" X 3"	1
A112	8" X 3"	1
A113	6" X 3"	1
A113	8" X 3"	1
A114	6" X 3"	1
A114	8" X 3"	1
A115	6" X 3"	1
A115	8" X 3"	1
A121	6" X 3"	1
A121	8" X 3"	1
A122	6" X 3"	1
A122	8" X 3"	1
A123	6" X 3"	1
A123	8" X 3"	1
A124	6" X 3"	1
A124	8" X 3"	1
A125	6" X 3"	1
A125	8" X 3"	1
A140	4" X 4"	4
A155	1 1/2" X 1 1/2"	12
A155	2 1/2" X 2 1/2"	6
A156	1 1/2" X 1 1/2"	12
A156	2 1/2" X 2 1/2"	6
A170		100
A190T	1 1/2" X 1 1/2"	20
A201	2 1/2" X 2 1/2"	1
A202	2 1/2" X 2 1/2"	1

Fig.	Size	Q.ty x Carton
A204	2 1/2" X 2 1/2"	1
R910	1/2"	100
R910	3/4"	100
R910	1"	50
R910	1 1/4"	20
R910	1 1/2"	20
R910	2"	20
R910	2 1/2"	4
R910	3"	2
R910	4"	2